



Supported Independent Living in Carrum

Property ID: 286

Vacancies: 3



Bedrooms:
5



Bathrooms:
2



Property Owner:
Department of
Families, Fairness
and Housing (DFFH)



**NDIS Funded
SDA Design Category:**
Fully Accessible



Support provided:
Active Night



*Your
new home*

A home filled with natural light in a stunning location next to the Patterson river and near the beach.

Features

- Spacious combined living and meals area.
- Back patio area perfect for relaxing.
- Plenty of natural light from large windows in the living areas.
- Two large accessible bathrooms each with a shower, bath, and toilet.
- Broadband internet.

Current residents

- The current residents are all female and are aged between 40-55 years.
- The house would best suit someone who enjoys spending time on their own hobbies or interests, or who likes to have family and friends over.
- Residents enjoy varied activities such as baking, watching movies and seeing family.

Bedroom features

- Built in robes.
- Heating and cooling.

Local area

- Only 1km from Carrum Station, bus stops and a taxi zone.
- Close to shops, restaurants and medical facilities.
- Next to the scenic Patterson River and walking distance to Carrum beach.

Interested in applying?

Before applying, make sure:

- The applicant is aged 18 years or over.
- The applicant has approved SDA eligibility and NDIA funding at the appropriate level.
- The applicant has the financial means to pay rent and utilities and is prepared to sign (or a representative to sign) a residential agreement.
- Specialist Disability Accommodation (SDA) design category for this house is Fully Accessible.

Find out how this can be your new home

To apply, or for more details about this vacancy, contact DFFH on:

southvct@dffh.vic.gov.au
www.dffh.vic.gov.au

To arrange a time to visit, or for more details contact us on:

1300 472 673

VacancyEnquiries@scopeaust.org.au



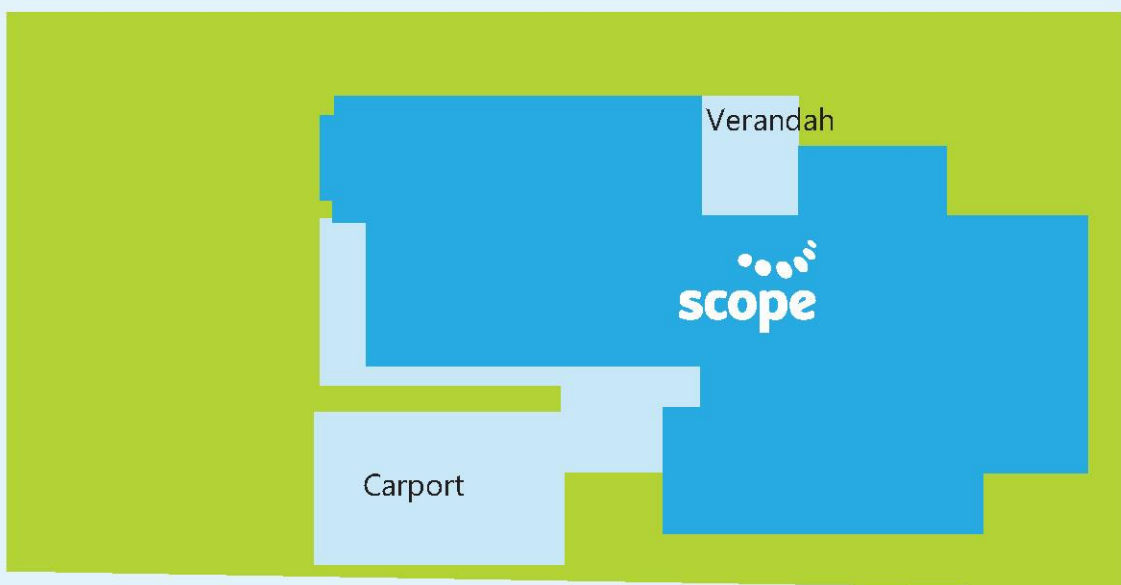
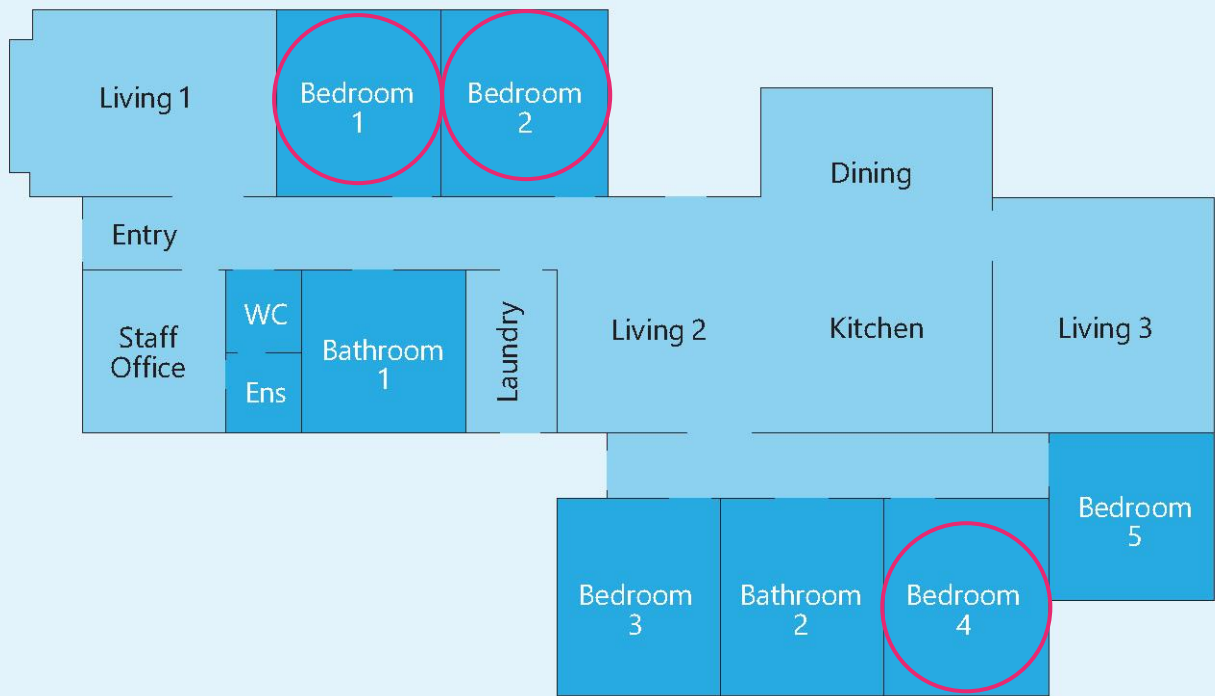

Making an enquiry

1300 472 673

VacancyEnquiries@scopeaust.org.au