

# Supported Independent Living in Carrum

Property ID: 339

Vacancies: 1



**Bedrooms:**  
5



**Bathrooms:**  
2



**Property Owner:**  
Department of  
Families, Fairness  
and Housing (DFFH)



**NDIS Funded  
SDA Design Category:**  
Fully Accessible



**Support provided:**  
Seven days per week  
with sleep over  
support model





*Your  
new home*

## A lovely home close to the scenic Patterson River and Carrum Beach.

### Features

- Open plan kitchen, dining and living area that leads to a back patio.
- Two separate living rooms.
- Two bathrooms with a bath, shower and toilet.
- Broadband internet access.
- Wheelchair accessible.

### Current residents

- The current residents are aged between 55-70 years and are all female.
- They enjoy a quiet home life and attend day services five days per week.

### Bedroom features

- Built in robes.
- Heating and cooling.

### Local area

- Only 1km from Carrum Station, bus stops and a taxi zone.
- A short walk to the closest bus stop.
- Close to shops, restaurants and medical facilities.
- Walking distance to Carrum Beach and the scenic Patterson River.

### Interested in applying?

#### Before applying, make sure:

- The applicant is aged 18 years or over.
- The applicant has approved SDA eligibility and NDIA funding at the appropriate level.
- The applicant has the financial means to pay rent and utilities and is prepared to sign (or a representative to sign) a residential agreement.
- Specialist Disability Accommodation (SDA) design category for this house is Fully Accessible.

### Find out how this can be your new home

To apply, or for more details about this vacancy, contact DFFH on:

eastvct@dffh.vic.gov.au  
www.dffh.vic.gov.au

To arrange a time to visit, or for more details contact us on:

1300 472 673

VacancyEnquiries@scopeaust.org.au

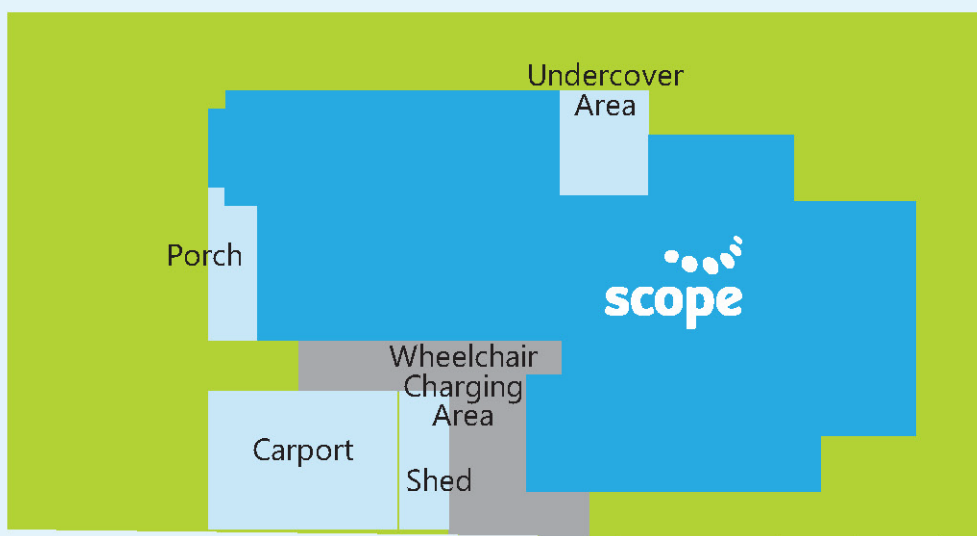
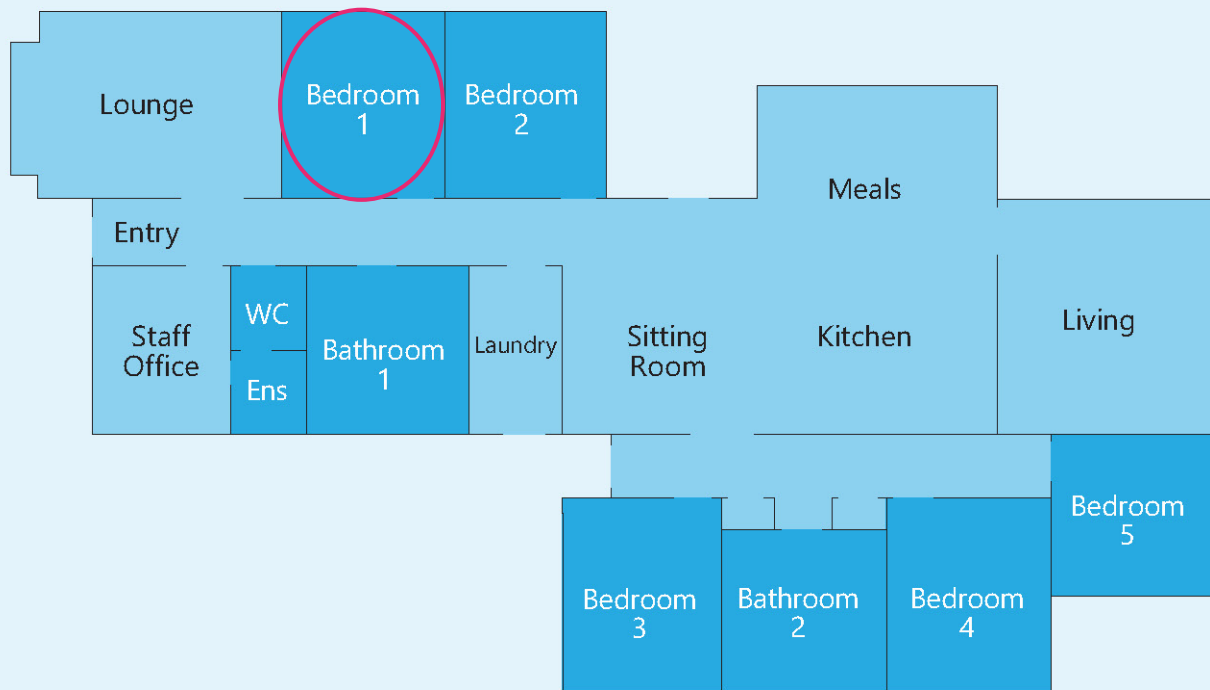

**Making an enquiry**

1300 472 673

[VacancyEnquiries@scopeaust.org.au](mailto:VacancyEnquiries@scopeaust.org.au)