



# Supported Independent Living in Hampton East

Property ID: 16

Vacancies: 1



**Bedrooms:**  
5



**Bathrooms:**  
2



**Property Owner:**  
Department of Families, Fairness and Housing (DFFH)



**NDIS Funded SDA Design Category:**  
Improved Liveability



**Support provided:**  
Seven days per week with sleep over support model





*Your  
new home*

## Relaxed, accessible home close to public transport and shops.

### Features

- All rooms are wheelchair accessible, and bathrooms all have ceiling hoists.
- Front entry and backyard both have ramps.
- Open plan kitchen and dining area.
- Broadband internet access.
- Pets are allowed.
- Property is owned by the Department of Families, Fairness & Housing (DFFH) and staff support is provided by Scope.
- Staff have manual handling skills and training.

### Current residents

- Two female residents and two male residents between the ages of 45-70 years old.
- All the residents get along well together and enjoy a relaxed, homely environment.

### Bedroom features

- Built-in robes.
- Heating and cooling.
- Ceiling hoist.

### Local area

- Walking distance to Moorabbin station, bus stops, cafes, and supermarket.
- Several opportunities to enjoy nature with Sandringham beach nearby as well as parks, lakes and reserves.

### Interested in applying?

#### Before applying, make sure:

- The applicant is aged 18 years or over.
- The applicant has approved Specialist Disability Accommodation (SDA) eligibility and NDIS funding at the appropriate level.
- The applicant has the financial means to pay rent and utilities and is prepared to sign (or a representative to sign) a residential agreement.
- The SDA design category is Improved Liveability.

### Find out how this can be your new home

To apply or to arrange an inspection, contact DFFH on:

[southvct@dffh.vic.gov.au](mailto:southvct@dffh.vic.gov.au)

[www.dffh.vic.gov.au](http://www.dffh.vic.gov.au)

For SIL enquiries or for more details contact

Scope on:

1300 472 673

[contact@scopeaust.org.au](mailto:contact@scopeaust.org.au)



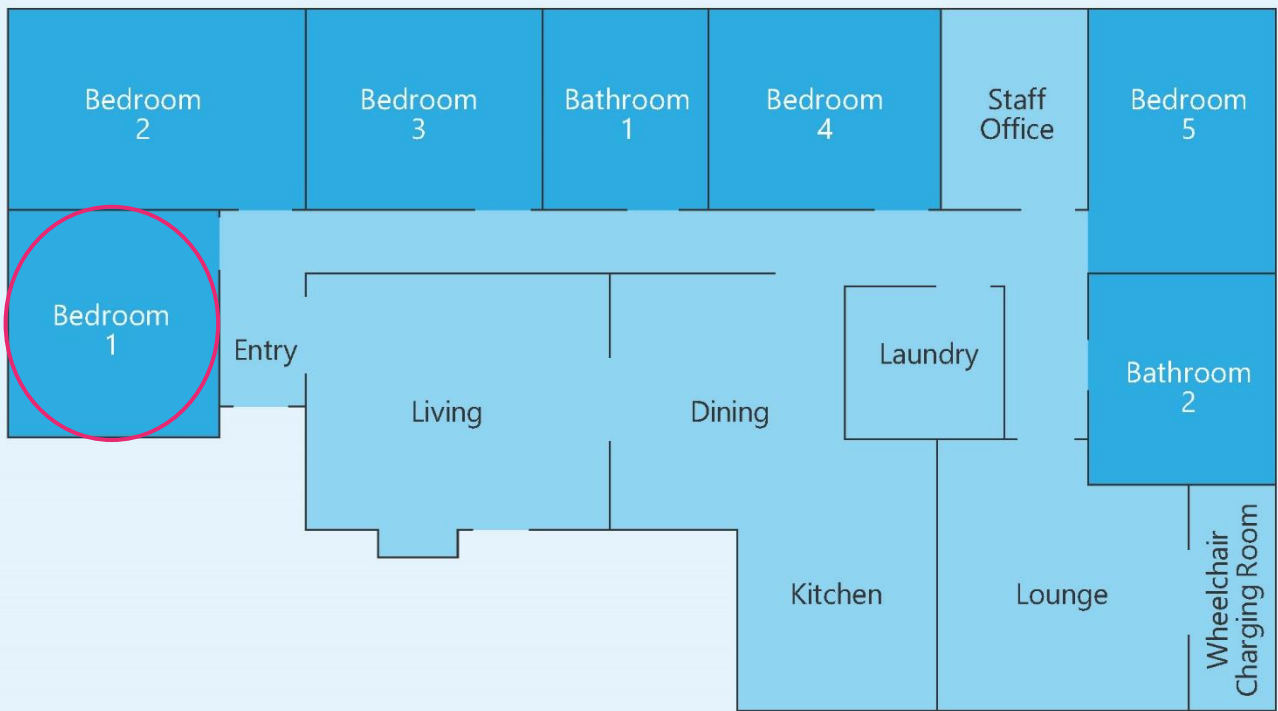

**Making an enquiry**

1300 472 673

[VacancyEnquiries@scopeaust.org.au](mailto:VacancyEnquiries@scopeaust.org.au)