

Supported Independent Living in Croydon

Property ID: 654

Vacancies: 2



Bedrooms:
5



Bathrooms:
2



Property Owner:
Department of Families, Fairness and Housing (DFFH)



NDIS Funded
SDA Design Category:
Robust housing



Support provided:
Seven days per week with sleep over support model



*Your
new home*

Enjoy relaxed living in the beautiful, family friendly suburb of Croydon.

Features

- Wide corridors and open plan design for ease of movement.
- Stepless front entry.
- Open plan kitchen, dining and living area.
- Two spacious living rooms.
- Purpose built property with accessible living areas and bathrooms.
- Pets are allowed to visit.
- Property is owned by the Department of Families, Fairness & Housing (DFFH) and staff support is provided by Scope.

Current residents

- Three male residents between the ages of 30-45 years old.
- They enjoy being out and about, watching movies and cooking.

Bedroom features

- Built-in robes.
- Heating and cooling.
- Plenty of natural light.

Local area

- Conveniently close to Croydon station, bus stops, hospital, cafes and restaurants.

- Several opportunities to enjoy the outdoors with both Adams reserve and Croydon Ranges football ground within walking distance.

Interested in applying?

Before applying, make sure:

- The applicant is aged 18 years or over.
- The applicant has approved Specialist Disability Accommodation (SDA) eligibility and NDIS funding at the appropriate level.
- The applicant has the financial means to pay rent and utilities and is prepared to sign (or a representative to sign) a residential agreement.
- The SDA design category is Robust Housing.

Find out how this can be your new home

To apply or to arrange an inspection, contact DFFH on:

eastvct@dffh.vic.gov.au

www.dffh.vic.gov.au

For SIL enquiries or for more details contact Scope on:

1300 472 673

contact@scopeaust.org.au

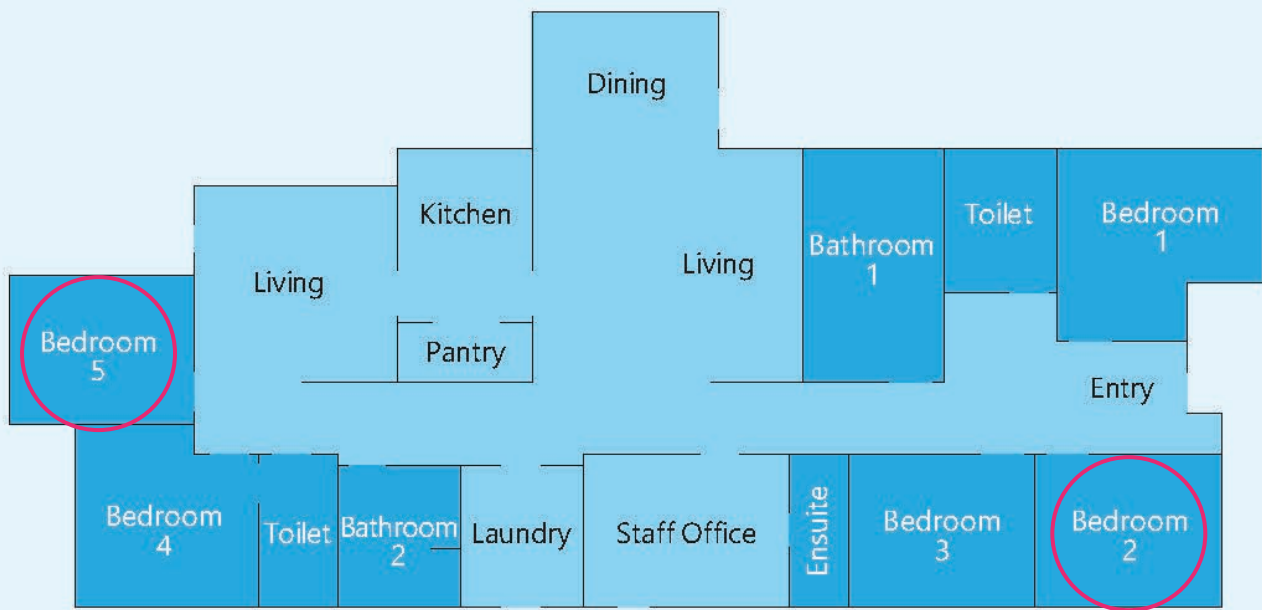

Making an enquiry

1300 472 673

VacancyEnquiries@scopeaust.org.au