



Supported Independent Living in Kew

Property ID: 675

Vacancies: 2



Bedrooms:
5



Bathrooms:
2



Property Owner:
Department of Families, Fairness and Housing (DFFH)



NDIS Funded SDA Design Category:
High Physical Support



Support provided:
Seven days per week with active night support



A lovely, quiet home conveniently close to public transport, shops and restaurants.

Features

- Open plan kitchen, dining and living area.
- Undercover outdoor seating area perfect for relaxing or entertaining.
- Two separate living rooms.
- Wheelchair accessible.
- Property is owned by the Department of Families, Fairness & Housing (DFFH) and staff support is provided by Scope.
- Staff have skills in peg feeding, bowel management/supps training, behaviour support, asthma management, and epilepsy training.

Current residents

- The current residents are aged between 35-65 years and are all female.
- The residents enjoy attending day programs and being in the community.
- They prefer a quiet and calm environment, and would love someone who would like to join them on bus rides and walks, afternoon cups of tea, and relaxing quietly in the lounge after dinner to watch TV.

Bedroom features

- Built-in robes.
- Heating and cooling.
- Ceiling hoist.

*Your
new home*

Local area

- Close to scenic nature walks along the Yarra River and Bellbird Park.
- Convenient access to buses, trams and restaurants at Kew Shopping Centre.
- Medical clinics and hospitals are nearby.

Interested in applying?

Before applying, make sure:

- The applicant is aged 18 years or over.
- The applicant has approved SDA eligibility and NDIA funding at the appropriate level.
- The applicant has the financial means to pay rent and utilities and is prepared to sign (or a representative to sign) a residential agreement.
- The Specialist Disability Accommodation (SDA) design category is High Physical Support.

Find out how this can be your new home

To apply or to arrange an inspection, contact DFFH on:

eastvct@dffh.vic.gov.au
www.dffh.vic.gov.au

For SIL enquiries or for more details contact Scope on:

1300 472 673

VacancyEnquiries@scopeaust.org.au

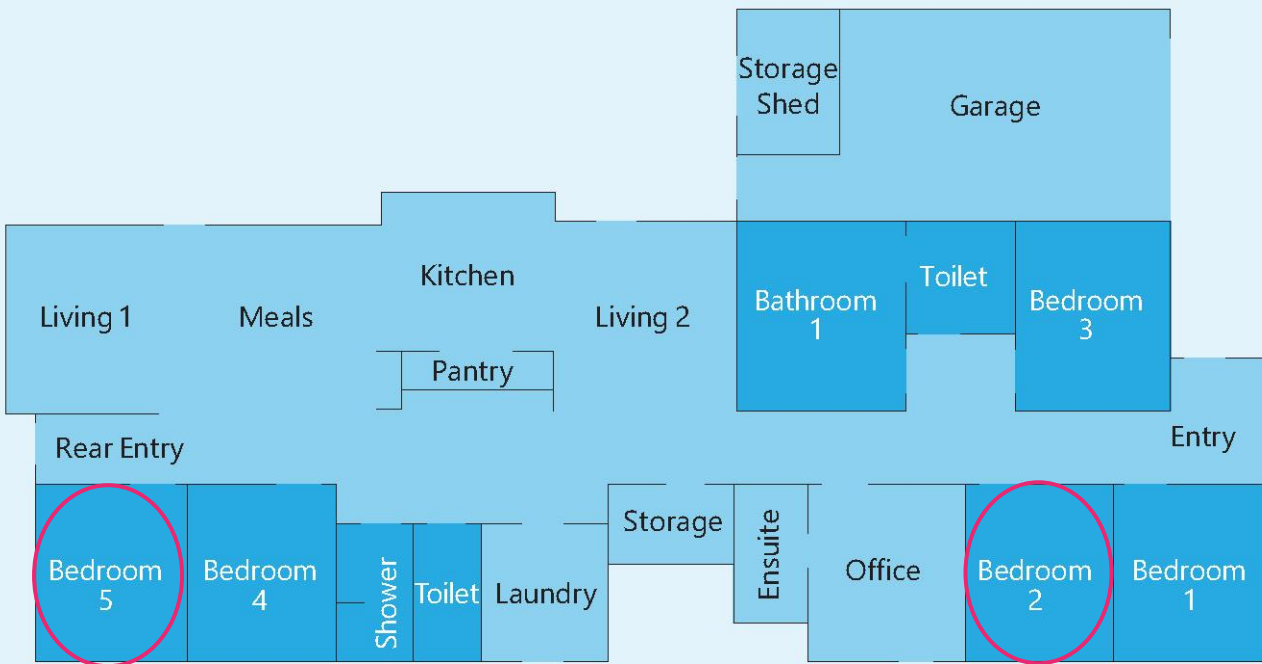

Making an enquiry

1300 472 673

VacancyEnquiries@scopeaust.org.au