



Supported Independent Living in Kew

Property ID: 676

Vacancies: 1



Bedrooms:
5



Bathrooms:
2



Property Owner:
Department of
Families, Fairness
and Housing (DFFH)



**NDIS Funded
SDA Design Category:**
Fully Accessible



Support provided:
Seven days per week
with sleep over
support model



*Your
new home*

Beautiful home with a tranquil garden, in a quiet, leafy suburb.

Features

- Open plan kitchen, dining and living area.
- Undercover outdoor seating area perfect for relaxing or entertaining.
- Two separate living rooms.
- Property is owned by the Department of Families, Fairness & Housing (DFFH) and staff support is provided by Scope.

Current residents

- Three male and one female resident aged between 25-85.
- The residents enjoy cooking, shopping, visiting cafes, movies, and catching up with friends.
- The ideal new resident will be a male who is independent and has good communication skills.

Bedroom features

- Built-in robes.
- Heating and cooling.

Local area

- Local shopping hub, including a supermarket and cafes only 1km from home.
- Easy access to public transport with trams and buses within walking distance.
- Plenty of recreation opportunities close by including Yarra Bend Park and Victoria Gardens Shopping Centre.

Interested in applying?

Before applying, make sure:

- The applicant is aged 18 years or over.
- The applicant has approved SDA eligibility and NDIA funding at the appropriate level.
- The applicant has the financial means to pay rent and utilities and is prepared to sign (or a representative to sign) a residential agreement.
- The Specialist Disability Accommodation (SDA) design category is Fully Accessible

Find out how this can be your new home

To apply or to arrange an inspection, contact DFFH on:
eastvct@dffh.vic.gov.au
www.dffh.vic.gov.au

For SIL enquiries or for more details contact Scope on:
1300 472 673
contact@scopeaust.org.au



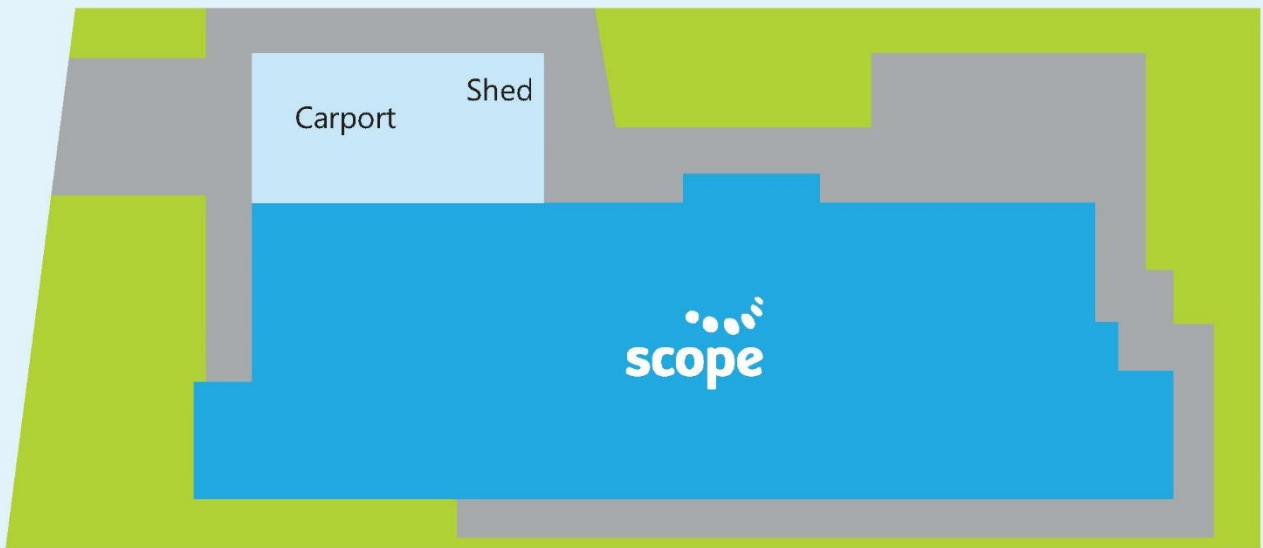
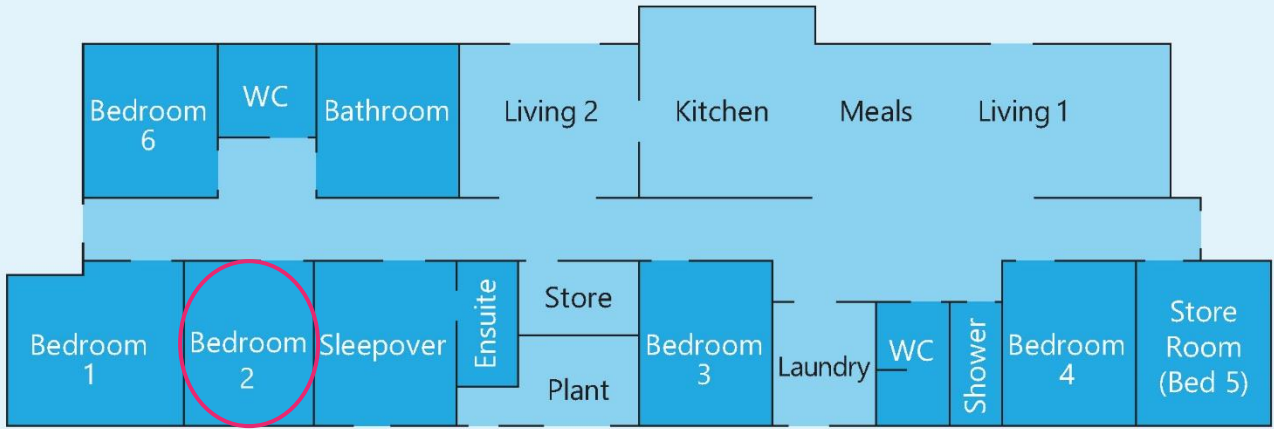

Making an enquiry

1300 472 673

VacancyEnquiries@scopeaust.org.au