



Supported Independent Living in Kew

Property ID: 687

Vacancies: 1



Bedrooms:
4



Bathrooms:
2



Property Owner:
Department of
Families, Fairness
and Housing (DFFH)



**NDIS Funded
SDA Design Category:**
Fully Accessible



Support provided:
7 days a week with
active night support



*Your
new home*

A fully accessible house close to public transport, shops and cafes.

Features

- Wide corridors and open plan design for ease of movement.
- Wheelchair accessible with stepless entries.
- Two spacious living rooms to relax in.
- Two bathrooms and two toilets. The large main bathroom has an overhead hoist.
- The backyard has a raised veggie garden and undercover seating area for outdoor enjoyment and entertaining.
- Regular active night staff who are trained in epilepsy and dysphagia management.
- This house is suitable for people with high support needs (including mobility support).

Current residents

- Two male residents and one female resident with ages between 60-80 years old.
- They enjoy relaxing in a quiet home environment, doing peaceful activities such as enjoying the garden on a sunny day.

Bedroom features

- Built in robes.
- Heating and cooling.
- Ceiling hoist.

Local area

- Conveniently close to tram services, bus stops, shops, parks and cafes.
- Easily accessible via the Eastern Freeway.

Interested in applying?

Before applying, make sure:

- The applicant is aged 18 years or over.
- The applicant has approved SDA eligibility and NDIA funding at the appropriate level.
- The applicant has the financial means to pay rent and utilities and is prepared to sign (or a representative to sign) a residential agreement.
- Specialist Disability Accommodation (SDA) category for this house is Fully Accessible.

Find out how this can be your new home

To apply or to arrange an inspection, contact DFFH on:

eastvct@dffh.vic.gov.au

www.dffh.vic.gov.au

For SIL enquiries or for more details contact

Scope on:

1300 472 673

contact@scopeaust.org.au

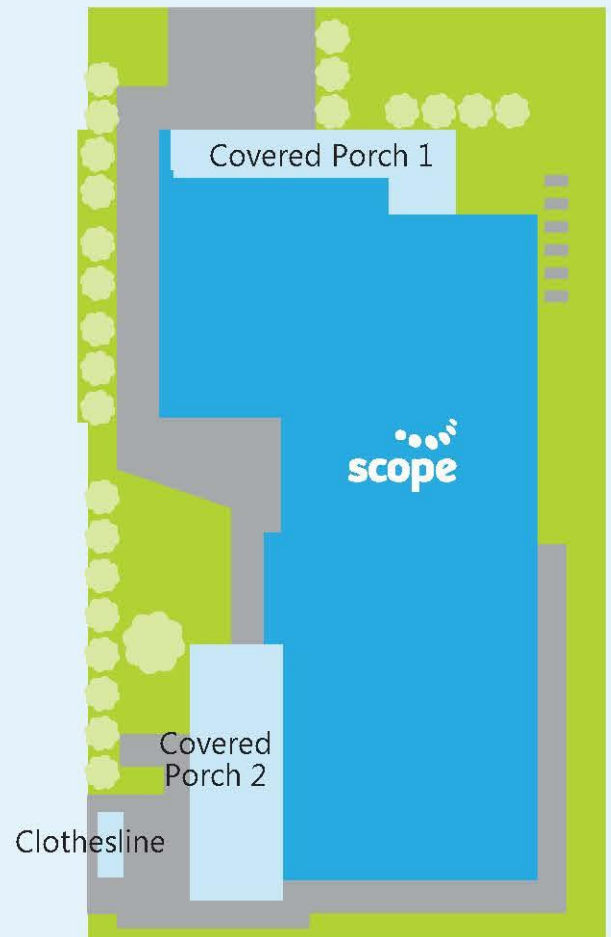
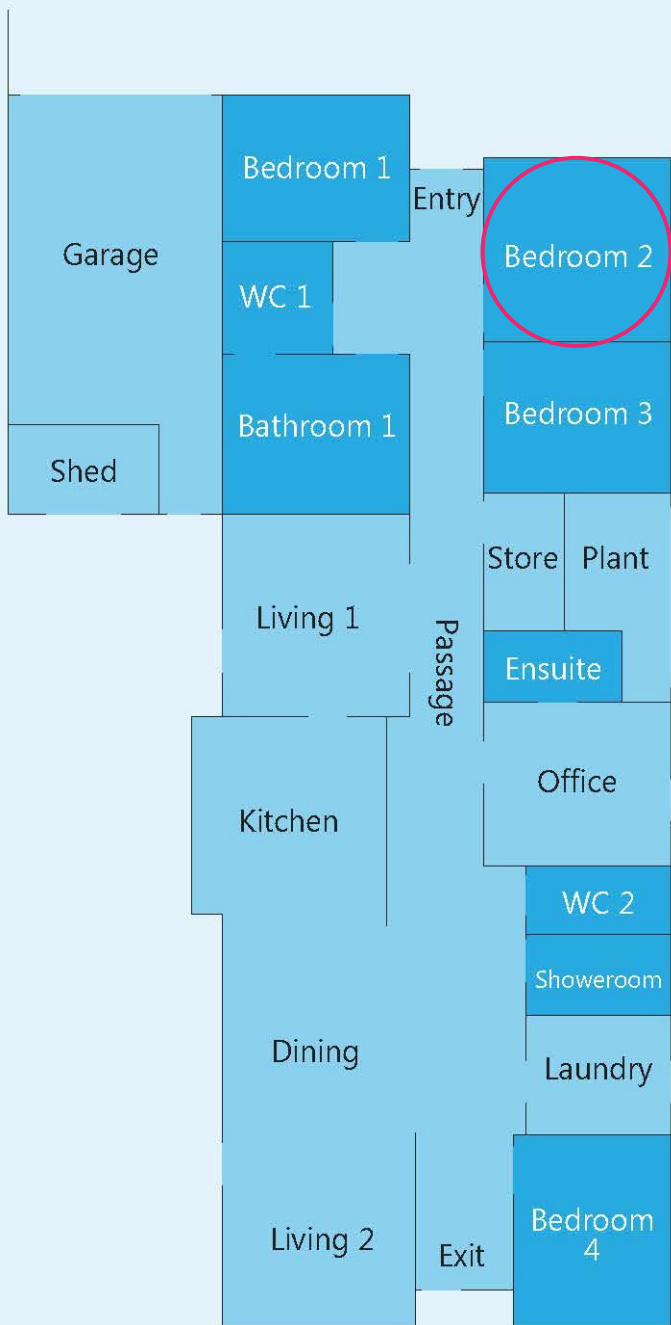

Making an enquiry

1300 472 673

contact@scopeaust.org.au