



# Supported Independent Living in Kew

Property ID: 689

Vacancies: 1



**Bedrooms:**  
5



**Bathrooms:**  
2



**Property Owner:**  
Department of  
Families, Fairness  
and Housing (DFFH)



**NDIS Funded  
SDA Design Category:**  
Robust



**Support provided:**  
Seven days per week  
with active night  
support



## Spacious home with a lovely outdoor seating area and garden.

*Your  
new home*

### Features

- Open plan kitchen, dining and living area.
- Lovely undercover outdoor seating area perfect for relaxing.
- Easy access Parker Bath.
- Two separate living rooms.
- Property is owned by the Department of Families, Fairness & Housing (DFFH) and staff support is provided by Scope.

### Current residents

- Four male residents between the ages of 50-77 years old.
- The current residents enjoy watching AFL, getting out and about, watching movies and gardening.
- They also enjoy participating in varied social activities within the local community.

### Bedroom features

- Built-in robes.
- Air conditioning and heating.

### Local area

- Close to scenic nature walks along the Yarra River and Bellbird Park. Park Avenue Reserve is also walking distance away.
- Convenient access to buses, trams and restaurants at Kew Shopping Centre.
- Medical clinics and hospitals are within a short drive away.

### Interested in applying?

**Before applying, make sure:**

- The applicant is aged 18 years or over.
- The applicant has approved SDA eligibility and NDIA funding at the appropriate level.
- The applicant has the financial means to pay rent and utilities and is prepared to sign (or a representative to sign) a residential agreement.
- The Specialist Disability Accommodation (SDA) design category is Robust.

### Find out how this can be your new home

To apply or to arrange an inspection, contact DFFH on:

[eastvct@dffh.vic.gov.au](mailto:eastvct@dffh.vic.gov.au)

[www.dffh.vic.gov.au](http://www.dffh.vic.gov.au)

For SIL enquiries or for more details contact Scope on:

1300 472 673

[contact@scopeaust.org.au](mailto:contact@scopeaust.org.au)



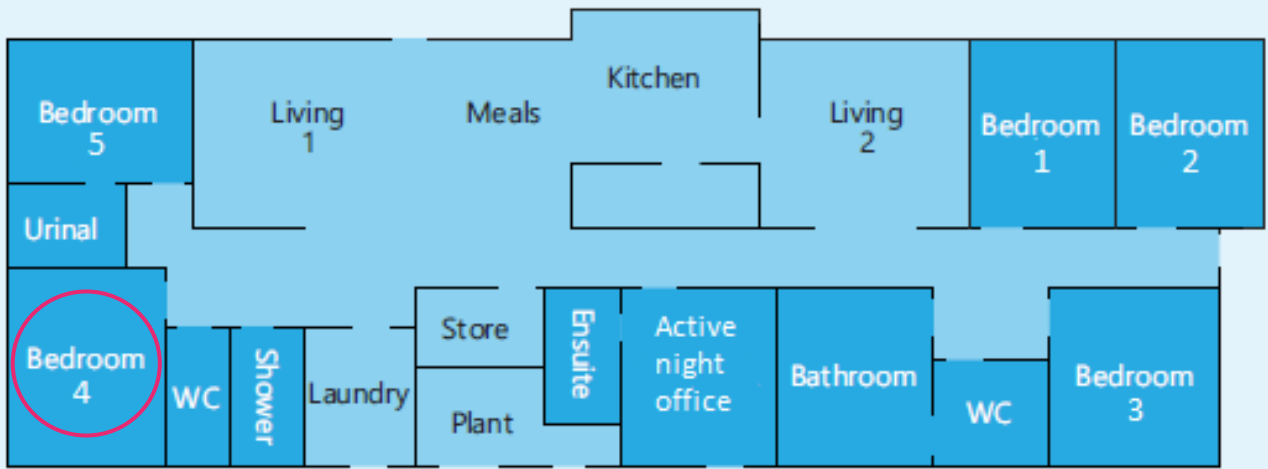

**Making an enquiry**

1300 472 673

[VacancyEnquiries@scopeaust.org.au](mailto:VacancyEnquiries@scopeaust.org.au)