



Supported Independent Living in Warrnambool

Property ID: 207
Vacancies: 2



Bedrooms:
5



Bathrooms:
2



Property Owner:
Department of
Families, Fairness
and Housing (DFFH)



**NDIS Funded
SDA Design Category:**
Improved Liveability



Support provided:
7 days per week
with sleepover
support model



Enjoy living close to the beach in this bright, spacious home.

*Your
new home*

Features

- Featuring a kitchen with a meals area, living area and a lounge room.
- Two bathrooms (each with a toilet), a third separate toilet and a laundry.
- Ceiling tracks in both bathrooms and front living area.
- This house is wheelchair accessible, except in the laundry.
- An undercover veranda which can be used for entertaining family and friends.
- The property is owned by DFFH and staff support is provided by Scope.

Current residents

- Two male and one female resident aged between 55 and 75 years old.
- The residents actively participate in their community with staff support, including going shopping, to the cinema, and out to the pub to see bands.
- They enjoy listening to music, cooking, and doing craft work.
- All residents attend a day program or 1:1 supported activities within the community.

Bedroom features

- Built-in robe.
- Evaporative cooling air and heating.
- Ceiling track in bedroom.

Local area

- Walking distance to bus stops and Northpoint Shopping Centre.
- Within a 5km radius there is a multiple pool complex, beach, hospital, medical clinic, CBD shopping centre, K-mart shopping complex, community hubs, religious centres, multiple parks, restaurants, hotels.

Interested in applying?

Before applying, make sure:

- The applicant is aged 18 years or over.
- The applicant has approved SDA eligibility and NDIA funding at the appropriate level.
- The applicant has the financial means to pay rent and utilities and is prepared to sign (or a representative to sign) a residential agreement.
- Specialist Disability Accommodation (SDA) category for this house is Improved Liveability.

Find out how this can be your new home

To apply or to arrange an inspection, contact DFFH on:

westvct@dffh.vic.gov.au
www.dffh.vic.gov.au

For SIL enquiries or for more details contact Scope on:

1300 472 673
contact@scopeaust.org.au

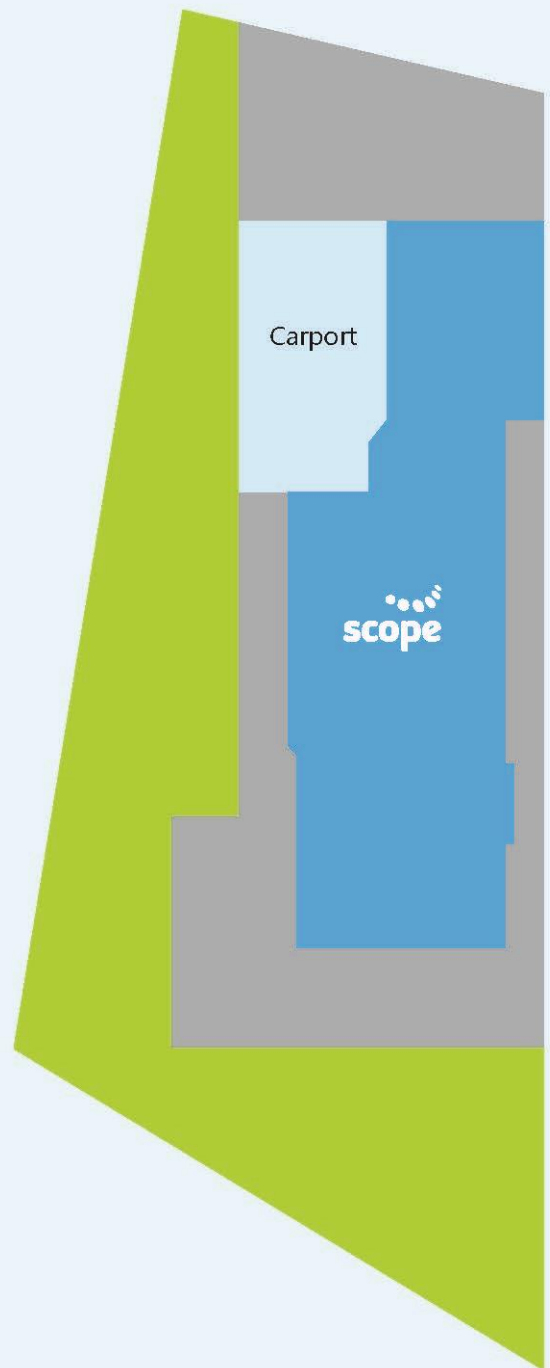
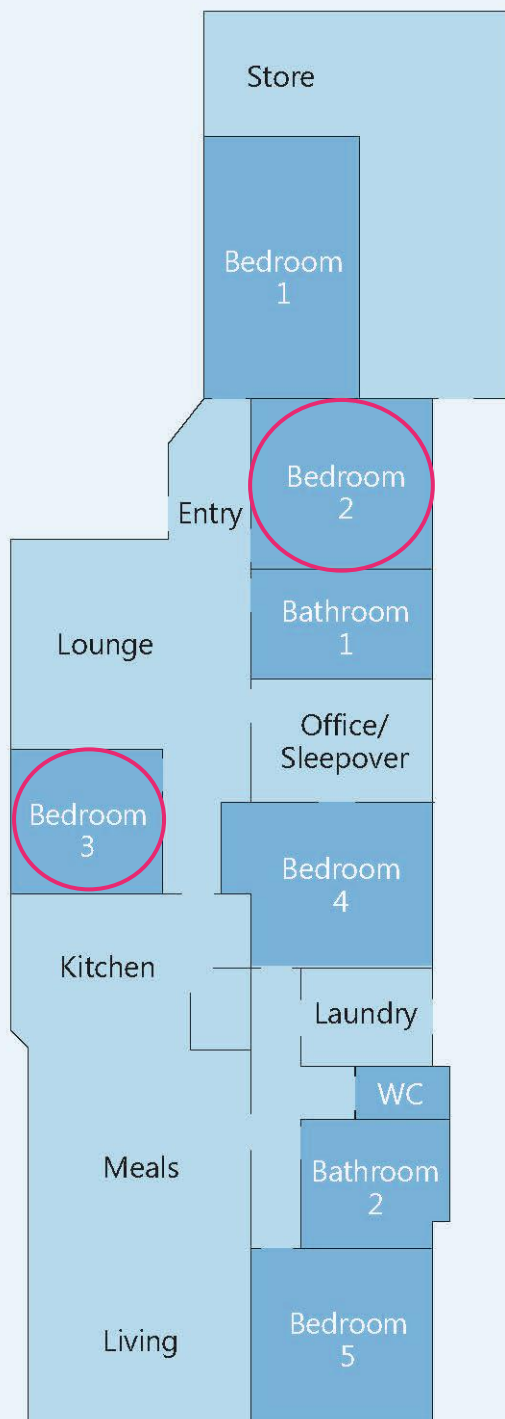

Making an enquiry

1300 472 673

VacancyEnquiries@scopeaust.org.au