



Supported Independent Living in Bellfield

Property ID: 581

Vacancies: 1



Bedrooms:
5



Bathrooms:
2



Property Owner:
Department of
Families, Fairness
and Housing (DFFH)



**NDIS Funded
SDA Design Category:**
Fully Accessible



Support provided:
Seven days per week
with active night
support



*Your
new home*

Spacious home with a lovely backyard close to shops and medical services.

Features

- Open plan kitchen, dining and living area.
- Lovely, spacious backyard with outdoor seating.
- Two separate living rooms to relax in.
- Wheelchair accessible.
- Home to a pet therapy dog.
- Property is owned by the Department of Families, Fairness & Housing (DFFH) and staff support is provided by Scope.

Current residents

- Four male residents between the ages of 40-65.
- They enjoy watching sports, TV, social outings and music.

Bedroom features

- Built-in robes.
- Heating and cooling.

Local area

- Close to Heidelberg Repatriation Hospital and Austin Hospital.
- Local shops, bus stop, cafes and restaurants are only a short distance away.
- Several beautiful parks and reserves nearby.

Interested in applying?

Before applying, make sure:

- The applicant is aged 18 years or over.
- The applicant has approved SDA eligibility and NDIA funding at the appropriate level.
- The applicant has the financial means to pay rent and utilities and is prepared to sign (or a representative to sign) a residential agreement.
- The Specialist Disability Accommodation (SDA) design category is Fully Accessible.

Find out how this can be your new home

To apply or to arrange an inspection, contact DFFH on:
northvct@dffh.vic.gov.au
www.dffh.vic.gov.au

For SIL enquiries or for more details contact Scope on:
1300 472 673
contact@scopeaust.org.au



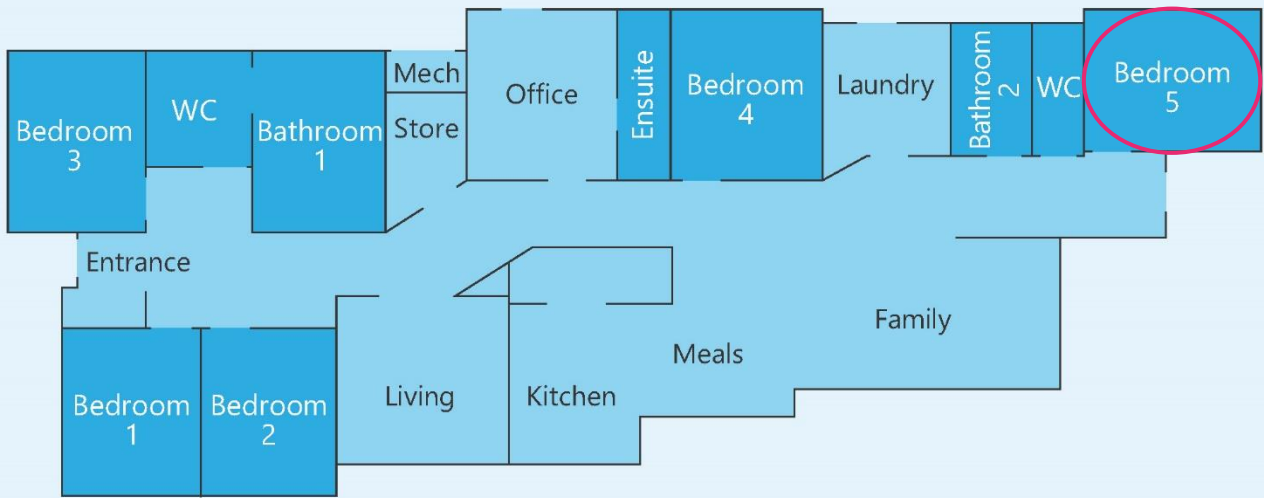

Making an enquiry

1300 472 673

VacancyEnquiries@scopeaust.org.au