



Supported Independent Living in Berwick

Property ID: 203

Vacancies: 2



Bedrooms:
5



Bathrooms:
2



Property Owner:
Department of Families, Fairness and Housing (DFFH)



NDIS Funded SDA Design Category:
Improved Liveability



Support provided:
Seven days per week with active night support



A quiet and relaxed home in Melbourne's South East suburbs.

*Your
new home*

Features

- The property is owned by the Department of Families, Fairness and Housing, and staff support is provided by Scope.
- Wheelchair accessible with rear stepless entries.
- Kitchen, meals and living areas provide ample space for socialising.
- Second living area for quiet times with family members or friends.
- Covered outdoor area with raised garden beds for peaceful outdoor enjoyment.

Current residents

- There is one male and one female aged between 60-70 years.
- Residents' interests and activities include Art, Football, music and getting out in the community.
- The ideal new resident will be a quiet, easy-going person who is sociable, but not too loud.

Bedroom features

- Built-in robes.
- Heating and cooling.

Local area

- The property overlooks spacious parkland and is conveniently close to a milk-bar.
- The local bus stop is a two-minute walk away.
- A commuter bus is available for resident outings and appointments with Wilson Botanic Park and

Westfield Fountain Gate Shopping Centre both in proximity to the house.

Interested in applying?

Before applying, make sure:

- The applicant is aged 18 years or over.
- The applicant has approved SDA eligibility and NDIA funding at the appropriate level.
- The applicant has the financial means to pay rent and utilities and is prepared to sign (or a representative to sign) a residential agreement.
- The Specialist Disability Accommodation (SDA) design category is Improved Liveability.

Find out how this can be your new home

To apply or to arrange an inspection, contact DFFH on:

southvct@dffh.vic.gov.au

www.dffh.vic.gov.au

For SIL enquiries or for more details contact Scope on:

1300 472 673

contact@scopeaust.org.au



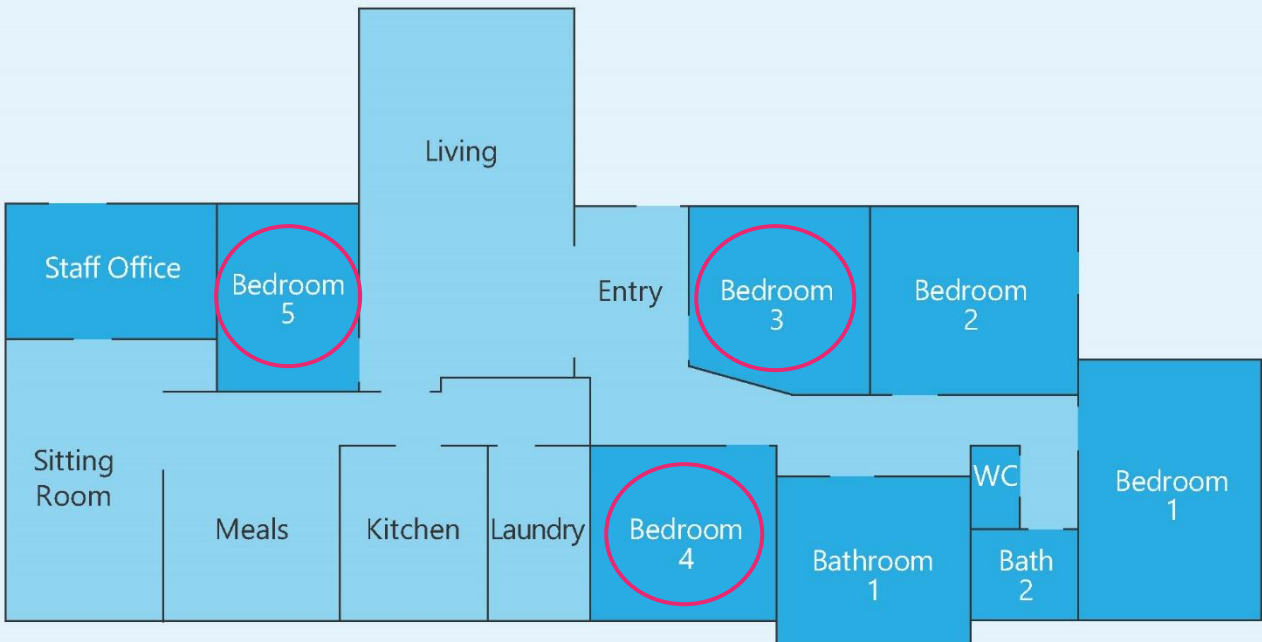

Making an enquiry

1300 472 673

VacancyEnquiries@scopeaust.org.au