



Supported Independent Living in St Albans

Property ID: 690

Vacancies: 1



Bedrooms:
5



Bathrooms:
2



Property Owner:
Department of Families, Fairness and Housing (DFFH)



NDIS Funded SDA Design Category:
High Physical Support



Support provided:
Seven days per week with active night support



*Your
new home*

Accessible, purpose-built home with a sensory room and great backyard area.

Features

- This home has been purpose-built to support people with high support needs.
- Wide corridors and open plan design for ease of movement.
- Accessible backyard with a lovely outdoor entertainment area and raised garden beds.
- A wonderful sensory room to relax in that has an overhead hoist.
- Fully wheelchair accessible.
- Pets are allowed.
- Property is owned by the Department of Families, Fairness & Housing (DFFH) and staff support is provided by Scope.
- Staff have skills in PEG feeding, manual handling, dysphagia management and more.

Current residents

- Two female residents and two male residents between the ages of 45-65 years old.
- They enjoy watching movies, listening to music, visiting family and spending time together.

Bedroom features

- Built-in robes.
- Heating and cooling.
- Ceiling hoist.
- Plenty of natural light.

Local area

- Brimbank Aquatic and Wellness Centre and shops are within walking distance.
- Close to public transport, with the nearest bus stop 250m away and Keilor Plains station 650m from the house.

Interested in applying?

Before applying, make sure:

- The applicant is aged 18 years or over.
- The applicant has approved Specialist Disability Accommodation (SDA) eligibility and NDIS funding at the appropriate level.
- The applicant has the financial means to pay rent and utilities and is prepared to sign (or a representative to sign) a residential agreement.
- The SDA design category is High Physical Support.

Find out how this can be your new home

To apply or to arrange an inspection, contact DFFH on:

westvct@dffh.vic.gov.au
www.dffh.vic.gov.au

For SIL enquiries or for more details contact

Scope on:

1300 472 673

contact@scopeaust.org.au

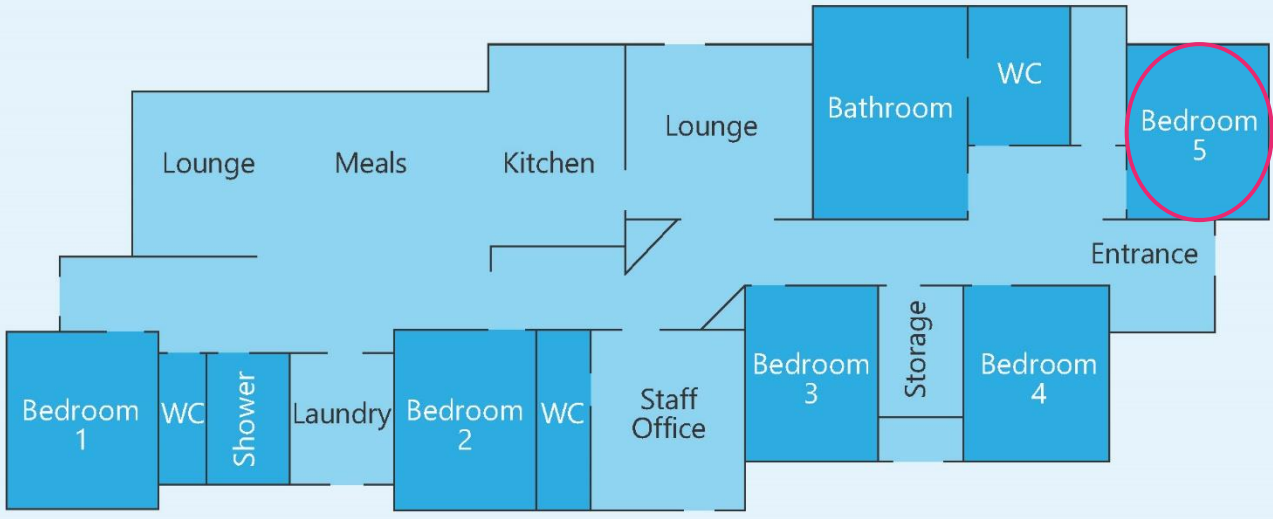

Making an enquiry

1300 472 673

VacancyEnquiries@scopeaust.org.au