



Supported Independent Living in Warranwood

Property ID: 265

Vacancies: 1



Bedrooms:
5



Bathrooms:
1 full bathroom
1 shower room
3 powder rooms



Property Owner:
Department of
Families, Fairness
and Housing (DFFH)



**NDIS Funded
SDA Design Category:**
Fully Accessible



Support provided:
Seven days per week
with active night



*Your
new home*

The perfect place to relax in, with two spacious living areas and a lovely courtyard garden.

Features

- Open plan kitchen and living space.
- Two large living areas perfect for relaxing or entertaining.
- Lovely courtyard and well-maintained garden.
- Pergola and outdoor seating area.
- A pet cat.
- Wheelchair accessible.
- Property is owned by the Department of Families, Fairness & Housing (DFFH) and staff support is provided by Scope.

Current residents

- Three female residents and one male resident with ages between 40-65 years old.
- They enjoy pottery, poetry, singing, going to the theatre, spending time with family and being in the community.

Bedroom features

- Built-in robes.
- Heating and cooling.
- Ceiling track.

Local area

- Quiet bushland setting close to several nature reserves and parks.
- Easy access to a bus stop within 100m.
- Eastland Shopping Centre and Maroondah Hospital are nearby.

Interested in applying?

Before applying, make sure:

- The applicant is aged 18 years or over.
- The applicant has approved SDA eligibility and NDIA funding at the appropriate level.
- The applicant has the financial means to pay rent and utilities and is prepared to sign (or a representative to sign) a residential agreement.
- The Specialist Disability Accommodation (SDA) design category is Fully Accessible.

Find out how this can be your new home

To apply or to arrange an inspection, contact DFFH on:
eastvct@dffh.vic.gov.au
www.dffh.vic.gov.au

For SIL enquiries or for more details contact Scope on:
1300 472 673
contact@scopeaust.org.au



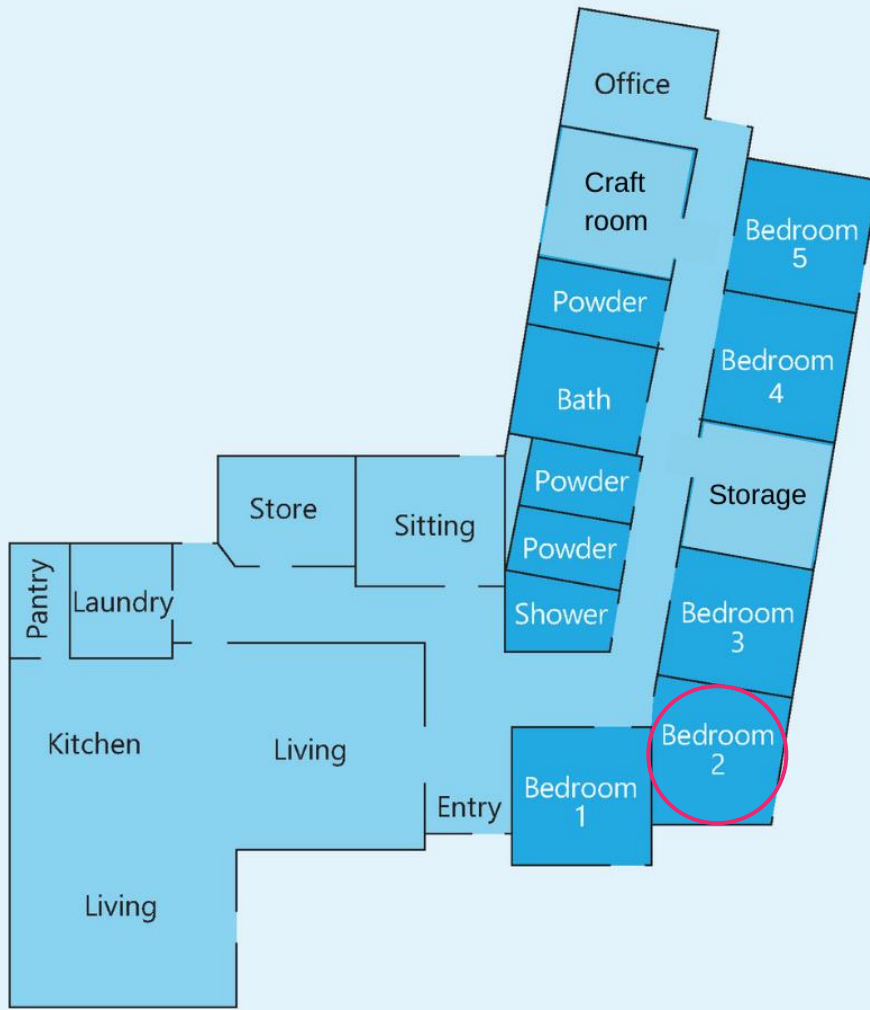

Making an enquiry

1300 472 673

VacancyEnquiries@scopeaust.org.au