



Supported Independent Living in Lysterfield

Property ID: 83

Vacancies: 1



Bedrooms:
5



Bathrooms:
2



Property Owner:
Department of Families, Fairness and Housing (DFFH)



NDIS Funded SDA Design Category:
Improved Liveability



Support provided:
Seven days per week with active night support



Lovely home in Melbourne's South Eastern suburbs.

*Your
new home*

Features

- Spacious dining area and two separate living rooms to relax in.
- Great backyard with raised gardens, BBQ area and outdoor seating.
- Pets are allowed.
- Staff are trained in manual handling and epilepsy support.
- Please note, this house is not suitable for a person who uses a wheelchair.

Current residents

- Four female residents between the ages of 55-85 years old.
- They enjoy music, singing, coffee, watching movies, going for picnics and catching up with friends and family.

Bedroom features

- Heating and cooling.
- Ceiling hoist.
- Plenty of natural light.

Local area

- Bus stop and several parks are close by.
- Wellington Village Shopping Centre is nearby.

Interested in applying?

Before applying, make sure:

- The applicant is aged 18 years or over.
- The applicant has approved Specialist Disability Accommodation (SDA) eligibility and NDIS funding at the appropriate level.
- The applicant has the financial means to pay rent and utilities and is prepared to sign (or a representative to sign) a residential agreement.
- The SDA design category is Improved Liveability.

Find out how this can be your new home

To apply or to arrange an inspection, contact DFFH on:

eastvct@dffh.vic.gov.au
www.dffh.vic.gov.au

For SIL enquiries or for more details contact

Scope on:

1300 472 673

contact@scopeaust.org.au



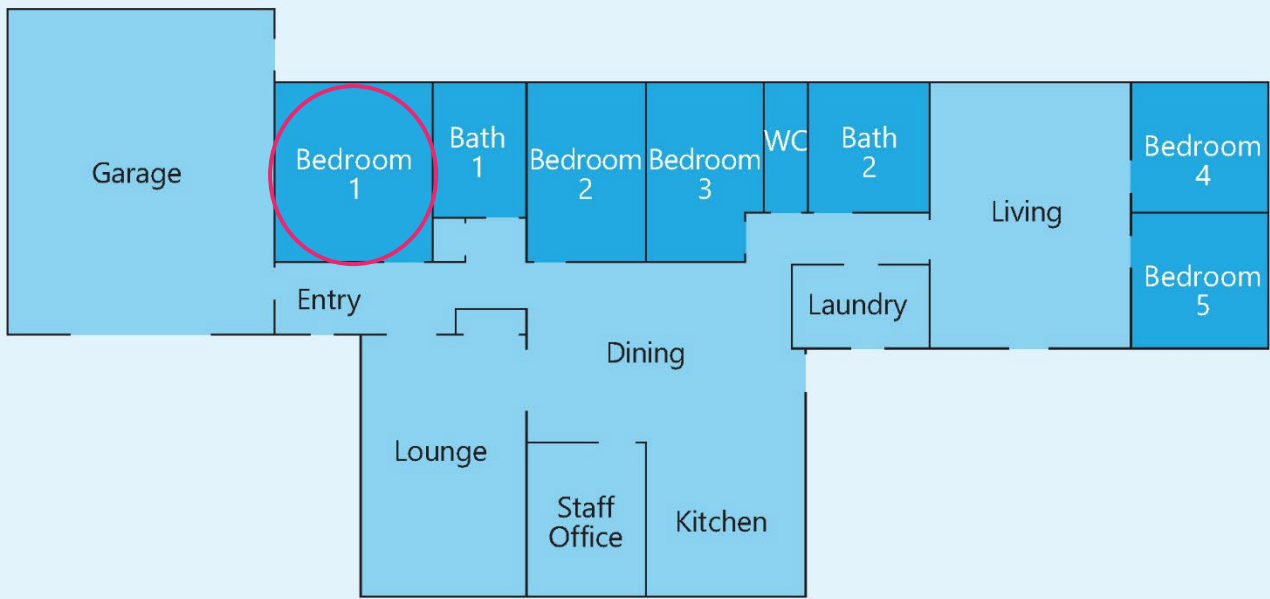

Making an enquiry

1300 472 673

VacancyEnquiries@scopeaust.org.au