



Supported Independent Living in Lara

Property ID: 1573

Vacancies: 2



Bedrooms:
2



Bathrooms:
2



Property Owner:
Department of
Families, Fairness
and Housing (DFFH)



**NDIS Funded
SDA Design Category:**
Robust



Support provided:
Seven days per week
with active night
support



*Your
new home*

Enjoy living in a spacious, open plan unit with a large backyard to relax in.

Features

- Two-bedroom unit with an open plan kitchen, dining and living area.
- Large backyard providing plenty of space to relax outdoors.
- Wheelchair accessible.
- Pets are allowed.
- Property is owned by DFFH and staff support is provided by Scope.
- This unit is connected to another 3-bedroom unit on the block.
- Vacancy is in Unit 2.

Current residents

- **Unit 1:** Three male residents with ages between 45-60 years old. They enjoy movies, keeping in touch with family, football, long drives and watching TV.
- **Unit 2:** No current residents.

Bedroom features

- Built-in robes.
- Heating and cooling.

Local area

- Only a 5-minute drive to Lara station, shops and restaurants
- Close to scenic nature parks and reserves.

Interested in applying?

Before applying, make sure:

- The applicant is aged 18 years or over.
- The applicant has approved SDA eligibility and NDIA funding at the appropriate level.
- The applicant has the financial means to pay rent and utilities and is prepared to sign (or a representative to sign) a residential agreement.
- The Specialist Disability Accommodation (SDA) design category is Robust.

Find out how this can be your new home

To apply or to arrange an inspection, contact DFFH on:

westvct@dffh.vic.gov.au
www.dffh.vic.gov.au

For SIL enquiries or for more details contact Scope on:
1300 472 673
contact@scopeaust.org.au

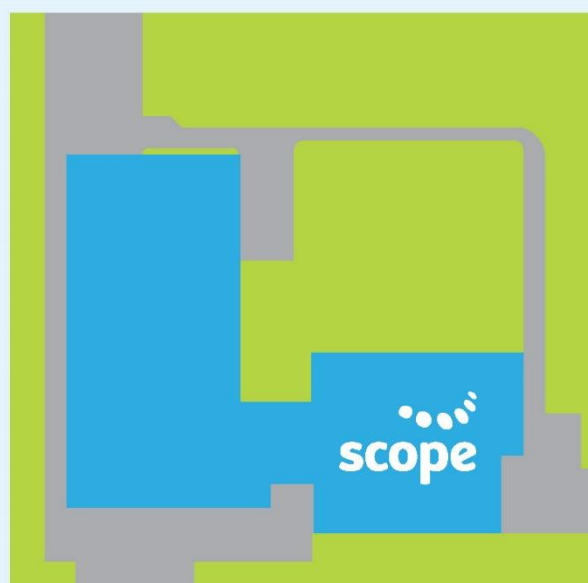
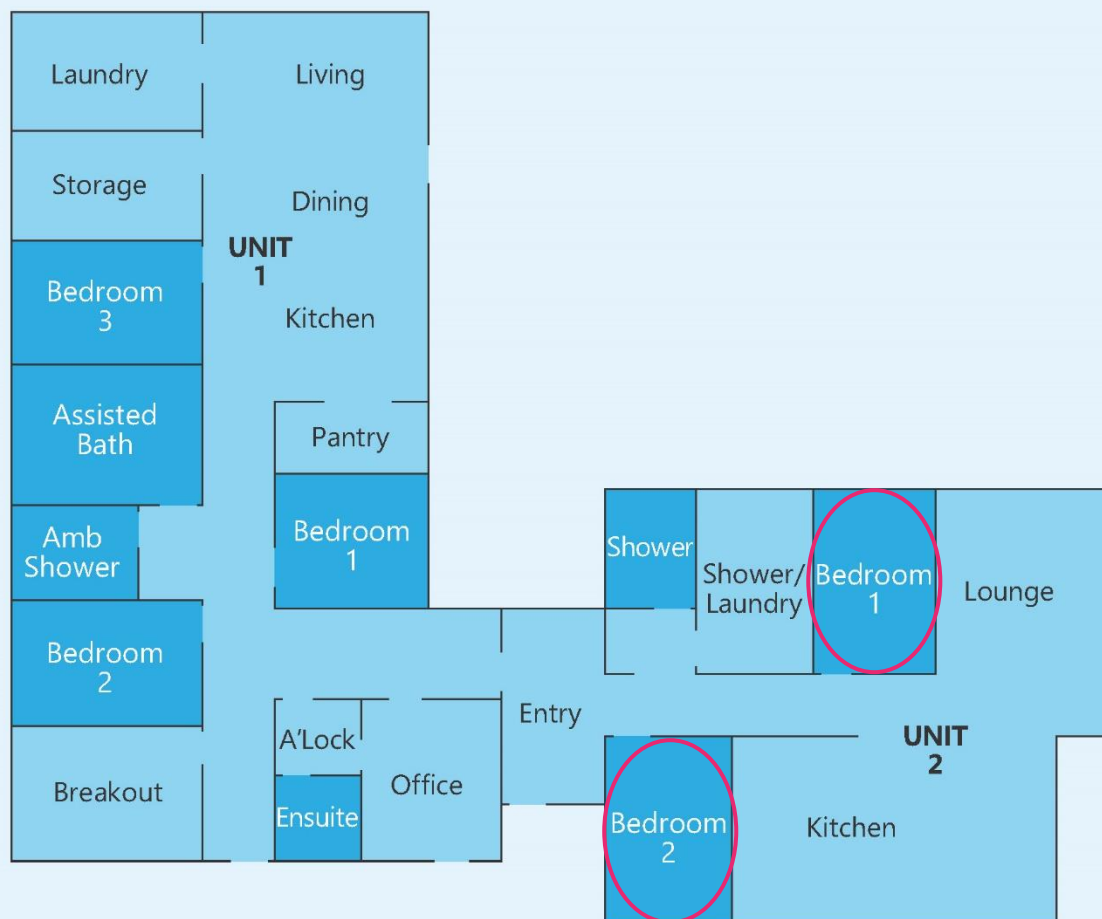

Making an enquiry

1300 472 673

contact@scopeaust.org.au