



Supported Independent Living in Altona Meadows

Property ID: 192
Vacancies: 1



Bedrooms:
5



Bathrooms:
2



Property Owner:
Department of
Families, Fairness
and Housing (DFFH)



NDIS Funded
SDA Design Category:
Improved Liveability



Support provided:
7 days a week with
sleepover support
model



***Your
new home***

Featuring two living rooms and an undercover outdoor entertaining area.

Features

- Accessible entries with ramps at the front and at the back of the house.
- Two bathrooms, a kitchen with open plan living and dining area.
- Multiple living areas to relax in.
- Undercover outdoor area, perfect for entertaining family and friends.
- This property is owned by the Department of Families, Fairness and Housing, and staff support is provided by Scope.

Current residents

- Three female residents and one male resident between 33-80.
- They enjoy socializing, reading books, playing cricket and going out for a meal.

Bedroom features

- Built-in robes.
- Heating and cooling.

Local area

- Short distance to Central Square Shopping Centre.
- Close to bus stops.
- Nearby parks, gardens and reserves.
- Short drive to Altona beach.

Interested in applying?

Before applying, make sure:

- The applicant is aged 18 years or over.
- The applicant has an appropriate level of NDIS funding.
- The applicant has the financial means to pay rent and utilities and is prepared to sign (or a representative to sign) a residential agreement.
- Specialist Disability Accommodation (SDA) category for this house is Improved Liveability.

Find out how this can be your new home

To apply, or for more details about this vacancy, contact DFFH on:

westvct@dffh.vic.gov.au

www.dffh.vic.gov.au

For SIL enquiries, contact Scope on:

1300 472 673

contact@scopeaust.org.au

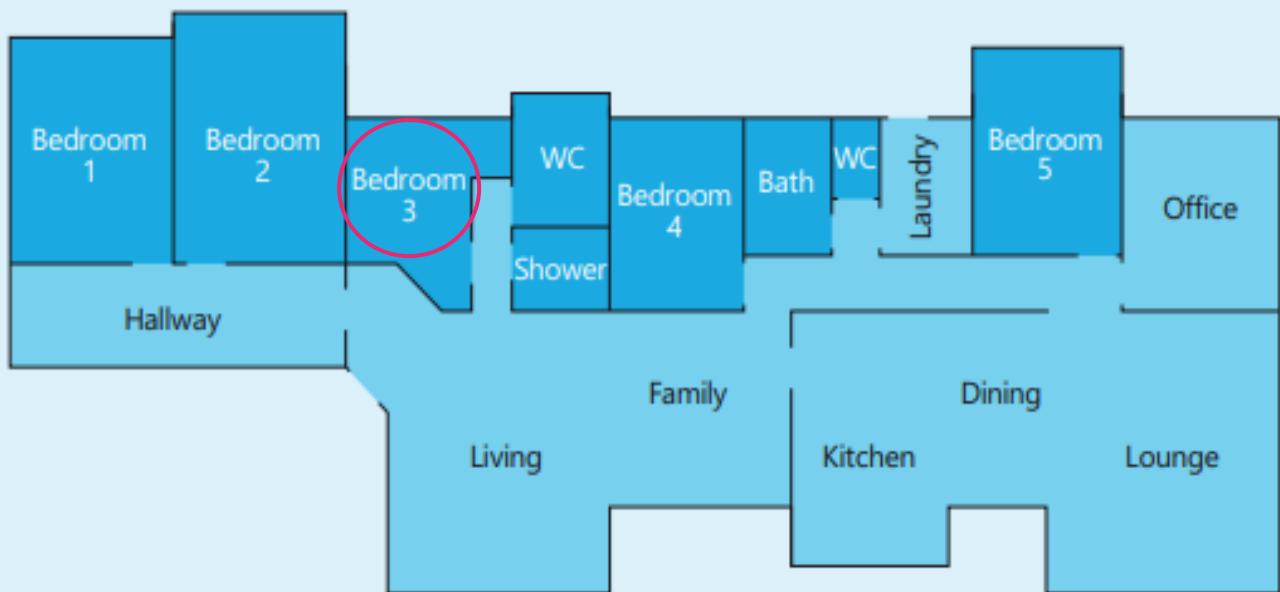

Making an enquiry

1300 472 673

contact@scopeaust.org.au