



# Supported Independent Living in Colac

**Property ID: 285**  
**Vacancies: 1**



**Bedrooms:**  
5



**Bathrooms:**  
2 fully accessible  
bathrooms plus  
additional toilet



**Property Owner:**  
Department of  
Families, Fairness  
and Housing (DFFH)



**NDIS Funded**  
**SDA Design Category:**  
High Physical Support



**Support provided:**  
7 day sleepover  
support





**Your  
new home**

## Spacious, purpose-built home with a large backyard and open-plan living areas.

### Features

- Contemporary, spacious purpose-built property with accessible living areas and bathrooms.
- Open plan kitchen, dining and living area.
- Two living rooms to relax in.
- Fully wheelchair accessible.
- Large backyard with a comfortable undercover outdoor seating area and raised veggie beds.
- Property is owned by the Department of Families, Fairness & Housing (DFFH) and staff support is provided by Scope.

### Current residents

- Two female and two male residents aged between 48-60 years old.
- Residents enjoy watching movies, listening to music, and living in a quiet and calm environment.

### Bedroom features

- Heating and cooling.
- Built in robes.

### Local area

- Close to Colac railway station bus stops.
- Local IGA is near to the house.
- Cafes and shops within a short 5-minute drive.
- Short distance to the beautiful Colac Botanic Gardens and Lake Colac Shore Reserve.

### Interested in applying?

#### Before applying, make sure:

- The applicant is aged 18 years or over.
- The applicant has approved SDA eligibility and NDIA funding at the appropriate level.
- The applicant has the financial means to pay rent and utilities and is prepared to sign (or a representative to sign) a residential agreement.
- Specialist Disability Accommodation (SDA) category for this house is High Physical Support.

### Find out how this can be your new home

To apply, or for more details about this vacancy, contact DFFH on:

[westvct@dffh.vic.gov.au](mailto:westvct@dffh.vic.gov.au)

[www.dffh.vic.gov.au](http://www.dffh.vic.gov.au)

To arrange a time to visit, or for more details contact us on:

1300 472 673

[contact@scopeaust.org.au](mailto:contact@scopeaust.org.au)

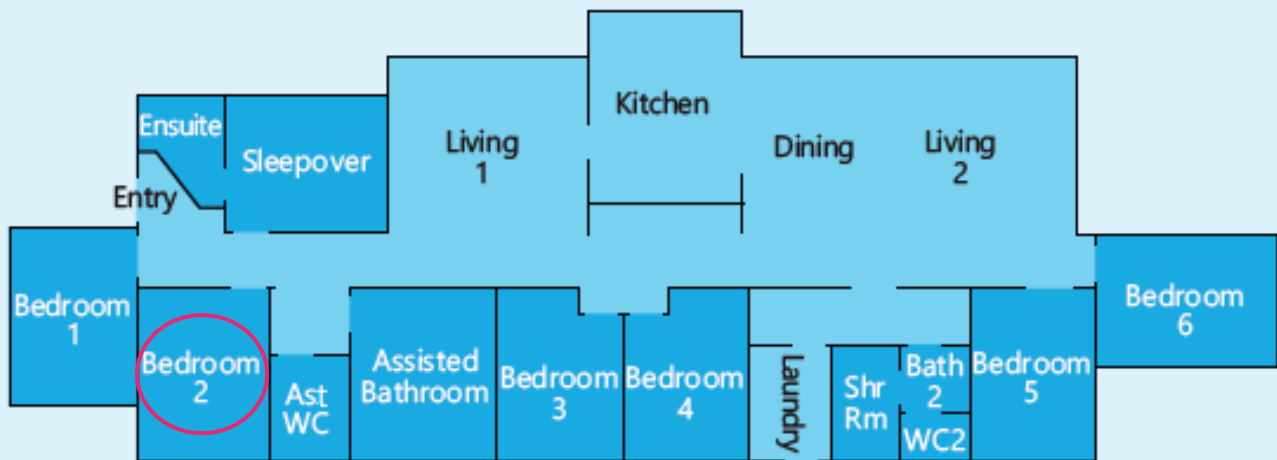

## **Making an enquiry**

1300 472 673

[VacancyEnquiries@scopeaust.org.au](mailto:VacancyEnquiries@scopeaust.org.au)