



# Supported Independent Living in Norlane

Property ID: 208

Vacancies: 1



**Bedrooms:**  
5



**Bathrooms:**  
2



**Property Owner:**  
Department of Families, Fairness and Housing (DFFH)



**NDIS Funded SDA Design Category:**  
Improved Liveability



**Support provided:**  
Active Night Support



## Beautiful home close to Geelong's North Shore Esplanade.

### Features

- Five-bedroom house with two bathrooms.
- Open plan living and dining area.
- Two main living areas.
- Undercover outdoor seating and spacious lawns provide plenty of room to relax.
- This house is accessible and able to support people with mobility needs.
- This property is owned by the Department of Families, Fairness and Housing (DFFH) with staff support from Scope.

### Current residents

- Two male and two female residents aged between 60-70 years.
- Current residents prefer a quiet environment.
- Residents attend a day program full-time and enjoy being active in their community.

### Bedroom features

- Large bedroom.
- Built in robes.
- Ceiling Hoist
- Wheelchair accessible.

### Local area

- Easily accessible public transport with multiple bus stops only a five-minute walk away.
- Geelong's CBD is only a fifteen-minute drive away with plenty of cafes and restaurants available.

*Your  
new home*

- Short drive to the nearest shopping centre.
- Several parks and ovals within 500 metres.
- Close to North Shore Esplanade with picturesque recreational opportunities and beautiful waterside views.

### Interested in applying?

#### Before applying, make sure:

- The applicant is aged 18 years or over.
- The applicant has approved SDA eligibility and NDIA funding at the appropriate level.
- The applicant has the financial means to pay rent and utilities and is prepared to sign (or a representative to sign) a residential agreement.
- The Specialist Disability Accommodation (SDA) design category for this house is Improved Liveability.
- The SDA building type for this house is Group Home.

### Find out how this can be your new home

To apply, or for more details about this vacancy, contact DFFH on:

[westvct@dffh.vic.gov.au](mailto:westvct@dffh.vic.gov.au)  
[www.dffh.vic.gov.au](http://www.dffh.vic.gov.au)

To arrange a time to visit, or for more details contact us on:

1300 472 673

[VacancyEnquiries@scopeaust.org.au](mailto:VacancyEnquiries@scopeaust.org.au)

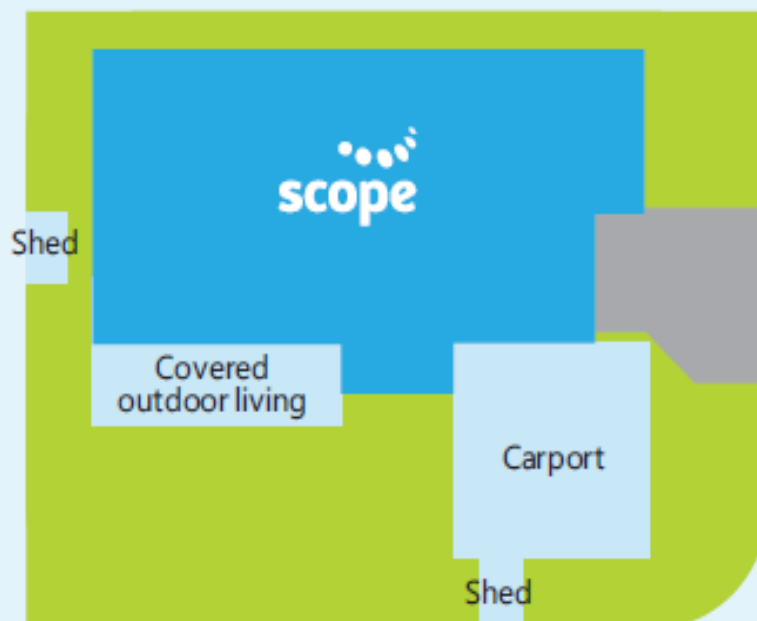
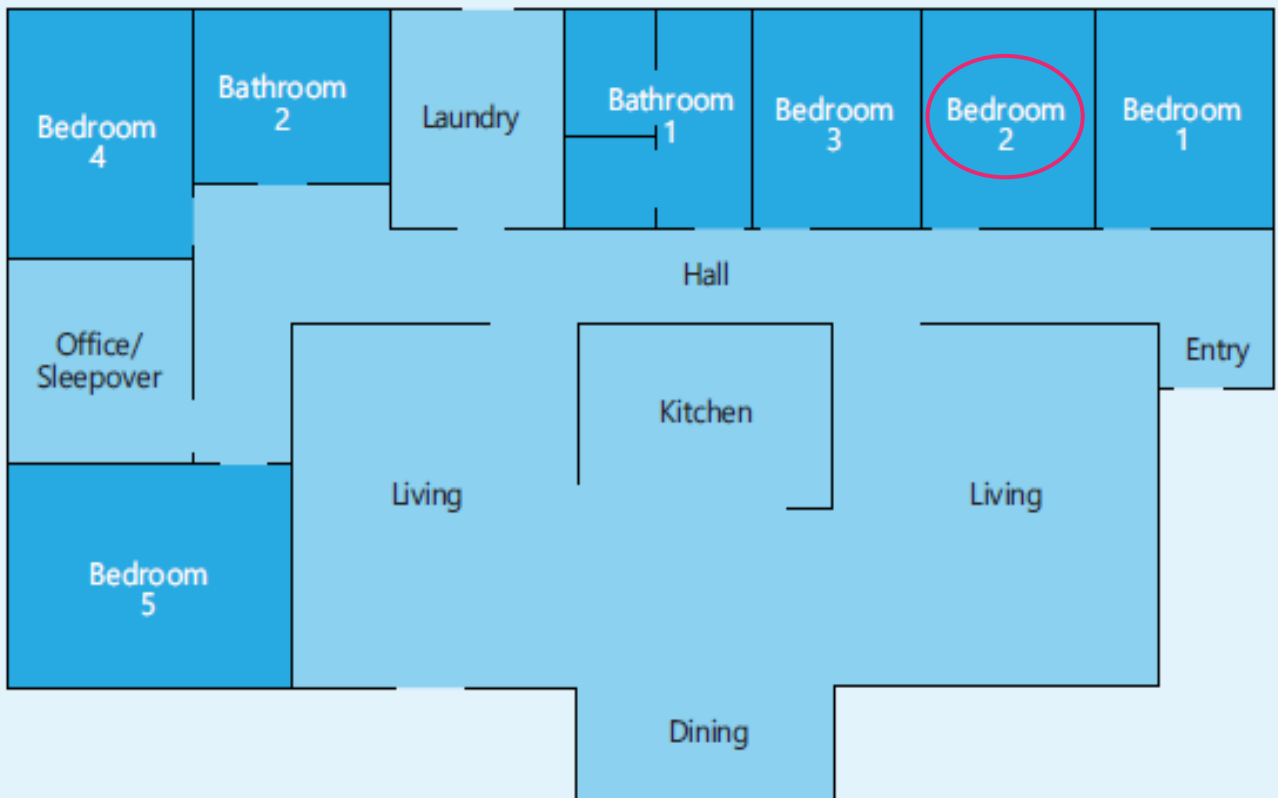

**Making an enquiry**

1300 472 673

[VacancyEnquiries@scopeaust.org.au](mailto:VacancyEnquiries@scopeaust.org.au)