



Supported Independent Living in Beechworth

Property ID: 710

Vacancies: 1



Bedrooms:
5



Bathrooms:
2



Property Owner:
Department of
Families, Fairness
and Housing (DFFH)



**NDIS Funded
SDA Design Category:**
High Physical Support



Support provided:
7 days per week
with a sleepover
support model



*Your
new home*

Enjoy living in a fantastic home, close to the main township in Beechworth

Features

- Wide corridors and open plan design for ease of movement.
- Open plan kitchen, dining and living area.
- Undercover outdoor seating area perfect for relaxing or entertaining.
- Two separate living rooms.
- Pets are allowed.
- Property is owned by the Department of Families, Fairness & Housing (DFFH) and staff support is provided by Scope.

Current residents

- Four female residents between the ages of 23-65 years old.
- They enjoy craft activities, going for walks, dining at restaurants and shopping.

Bedroom features

- Built-in robes.
- Heating and cooling.
- Ceiling hoist.
- Plenty of natural light.

Local area

- Conveniently close to Beechworth's main township with multiple cafes and restaurants.
- Several opportunities to enjoy nature with Queen Victoria Park nearby as well as Lake Sambell reserve.
- Bus stop only 600m away.

Interested in applying?

Before applying, make sure:

- The applicant is aged 18 years or over.
- The applicant has secured an appropriate level of NDIS funding.
- The applicant has the financial means to pay rent and utilities and is prepared to sign (or a representative to sign) a residential agreement.
- Specialist Disability Accommodation (SDA) design category for this house is High Physical Support.
- The SDA building type for this house is Group Home.

Find out how this can be your new home

To apply, or for more details about this vacancy, contact DFFH on:

eastvct@dffh.vic.gov.au

www.dffh.vic.gov.au

For SIL enquiries, contact Scope on:

1300 472 673

VacancyEnquiries@scopeaust.org.au

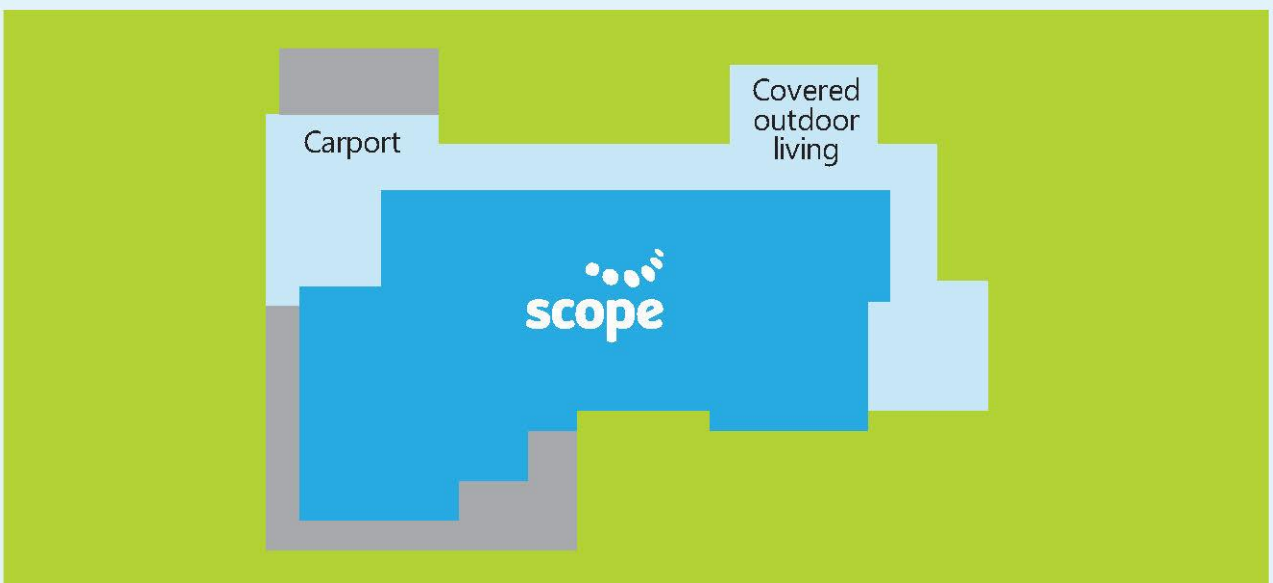
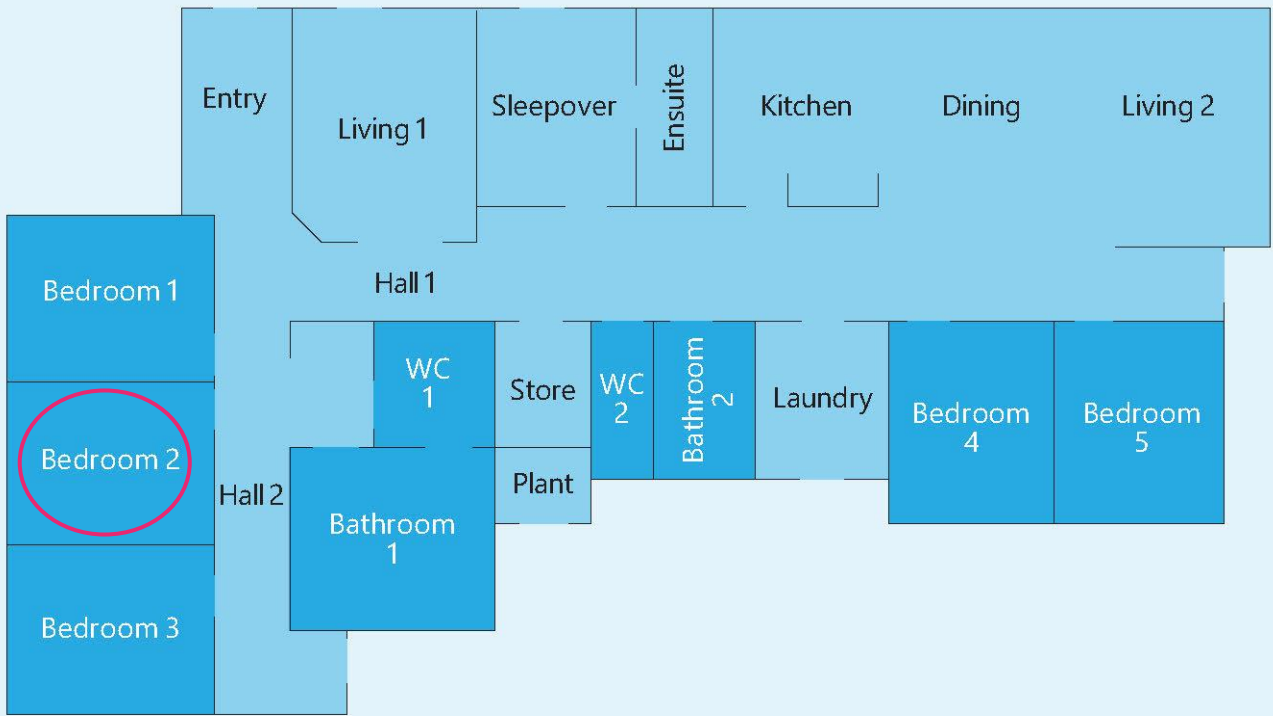

Making an enquiry

1300 472 673

VacancyEnquiries@scopeaust.org.au