



Pascoe Vale, VIC 3044



3 Bed



3 Bath



Your SDA Provider: InHab



2 Vacancy across the two 3-bedroom houses



Most suitable for: Male or Female



4 min to nearest Medical Centre

8 min drive to Glenroy shopping strip

4 min to Oak Park Railway Station



2 min to local bus stop

1 min to nearest park

Modern 3-bedroom homes

A suite of 2 x 3-bedroom houses designed for High Physical Support living. This SDA offers independence, comfort, and contemporary design.

Availability

- Available now.

Property Features

- Modern, purpose-built homes
- Open living, dining and kitchen
- Assistive technology and home automation
- Modern kitchens with customisable features
- Bedrooms with private ensuite
- Expansive backyard and entertainment area
- Fully landscaped garden
- Wheelchair accessible with wide doorways and pathways throughout.
- Coburg Social Connections is also nearby.

To register your interest, please contact us via:



1300 472 673



contact@scopeaust.org.au



scopeaust.org.au





Suitable for

- Built to a High Physical Support Specification.
- Suited to residents with Improved Liveability, Fully Accessible or High Physical support funding.



Your Support Team

- Staff are trained to deliver a high level of support across multiple disabilities.
- Staff are trained in supporting participants to access and engage in the local community at a one-to-one level or within a group setting.
- Capacity to implement restrictive practices where required (in line with legislation and best practice).
- Behaviour support / epilepsy / diabetes / mealtime management.
- Sleep over support shift.

Site Map

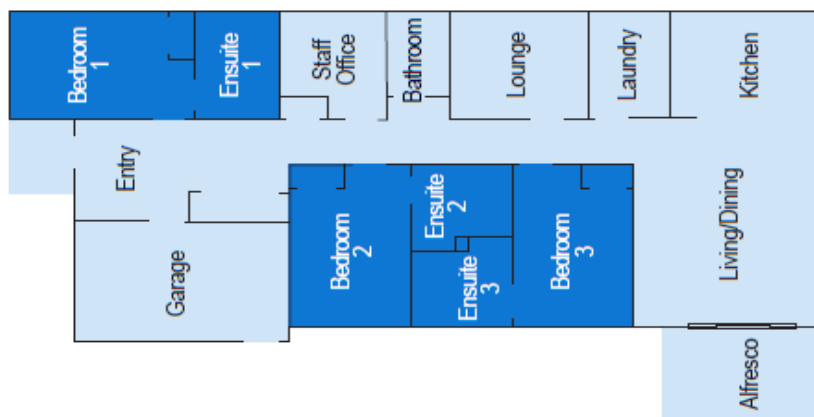

Become a resident of Scope's Supported Independent Living homes and enjoy new surroundings and friends.



To register your interest, please contact us via:

📞 1300 472 673

✉ contact@scopeaust.org.au

🌐 scopeaust.org.au

