



Supported Independent Living in Grovedale

Property ID: 714

Vacancies: 1



Bedrooms:
5



Bathrooms:
2



Property Owner:
Department of
Families, Fairness
and Housing (DFFH)



**NDIS Funded
SDA Design Category:**
High Physical Support



Support provided:
Sleepover support
provided 7 days a
week



*Your
new home*

Enjoy living in a relaxed, spacious home close to public transport.

Features

- Open plan design for ease of movement.
- Stepless entry to the front & backyard.
- Open plan kitchen, dining and living area.
- Accessible living areas and bathrooms.
- Pets are allowed.
- Property is owned by the Department of Families, Fairness & Housing (DFFH) and staff support is provided by Scope.

Current residents

- Three female & one male residents aged between 30-65 years.
- The residents prefer a calm environment and love going out and about, listening to music and watching movies.

Bedroom features

- Heating and cooling.
- Ceiling track.
- Built-in robes.
- Plenty of natural light.

Local area

- Close to multiple medical services with Kardinia Health only walking distance away.
- Short distance from Marshall Railway Station.
- The local area is surrounded by parks and community spaces to enjoy.
- Short distance away from Waurin Ponds Shopping Centre.

Interested in applying?

Before applying, make sure:

- The applicant is aged 18 years or over.
- The applicant has approved SDA eligibility and NDIA funding at the appropriate level.
- The applicant has the financial means to pay rent and utilities and is prepared to sign (or a representative to sign) a residential agreement.
- Specialist Disability Accommodation (SDA) category for this house is Improved Liveability.

Find out how this can be your new home

To apply or to arrange an inspection, contact DFFH on:

westvct@dffh.vic.gov.au

www.dffh.vic.gov.au

For SIL enquiries or for more details contact

Scope on:

1300 472 673

contact@scopeaust.org.au

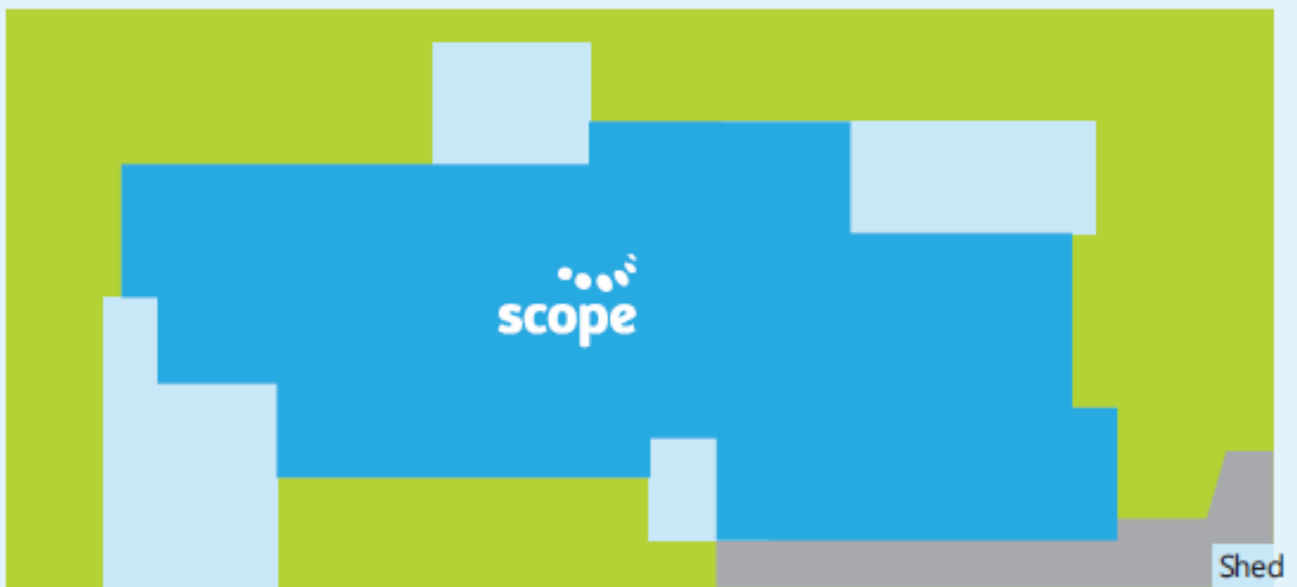
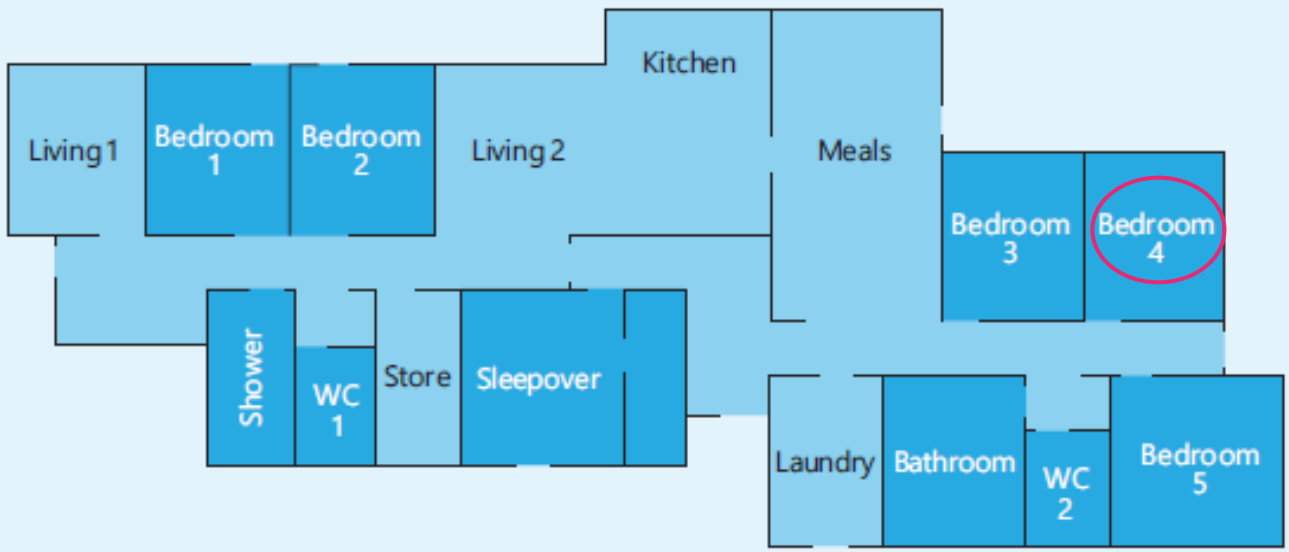

Making an enquiry

1300 472 673

VacancyEnquiries@scopeaust.org.au