



Supported Independent Living in Kew

Property ID: 672

Vacancies: 1



Bedrooms:
5



Bathrooms:
2



Property Owner:
Department
Families, Fairness
Housing (DFFH)



**NDIS Funded
SDA Design Category:**
High Physical Support



Support provided:
Active night



Relax outside in a lovely courtyard and enjoy living in the leafy suburb of Kew.

Features

- Fully wheelchair accessible.
- Two living areas and accessible bathrooms.
- Courtyard with trees, veggie planters and undercover outdoor seating.
- The property is owned by DFFH, and staff support is provided by Scope.
- Staff are trained in dual disability, behaviours of concern and epilepsy.

Current residents

- Current residents are males in their 70's.
- All residents attend supports during the day and enjoy structured routines.

Bedroom features

- Built in robes.
- Evaporative cooling air and heating.

Local area

- Fairfield train station is an eight-minute drive away, and bus stops are within walking distance.
- Kew Shopping centre and Bellbird Park are a short five-minute drive away.
- Cafes and shops are only a 10-minute walk away.

Interested in applying?

Before applying, make sure:

- The applicant is aged 18 years or over.
- The applicant has approved SDA eligibility and NDIA funding at the appropriate level.
- The applicant has the financial means to pay rent and utilities and is prepared to sign (or a representative to sign) a residential agreement.
- Specialist Disability Accommodation (SDA) design category for this house is High Physical Support.

Find out how this can be your new home

To apply, or for more details about this vacancy, contact DFFH on:

hcsenquiries@dffh.vic.gov.au

www.dffh.vic.gov.au

To arrange a time to visit, or for more details contact us on:

1300 472 673

contact@scopeaust.org.au

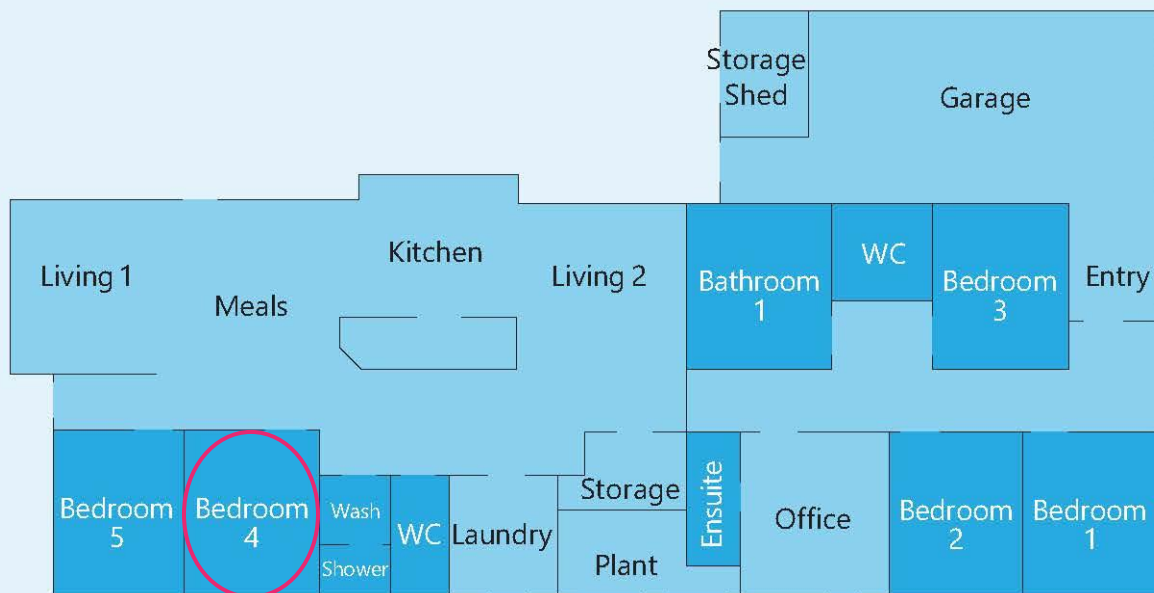

Making an enquiry

1300 472 673

VacancyEnquiries@scopeaust.org.au