



# Supported Independent Living in Warrnambool

Property ID: 743

Vacancies: 1



**Bedrooms:**  
3



**Bathrooms:**  
2



**Property Owner:**  
Department of Families, Fairness and Housing (DFFH)



**NDIS Funded SDA Design Category:**  
High Physical Support



**Support provided:**  
7 days per week with sleepover support



*Your  
new home*

## Great home with multiple living spaces and a fantastic outdoor area.

### Features

- Large open plan kitchen, living and dining area.
- Contemporary, undercover, outdoor entertainment area with a BBQ and swing chair.
- Multiple spacious living areas to relax in.
- Fully wheelchair accessible.
- Property has two cats and three birds.
- Property is owned by the Department of Families, Fairness and Housing and staff support is provided by Scope.

### Current residents

- Three female and one male resident between the ages of 28-64.
- Residents enjoy going on social outings, listening to music and spending time with family.

### Bedroom features

- Heating and cooling.
- Ceiling track.

### Local area

- Close to Warrnambool Railway Station, bus stops and local supermarkets.
- Surrounded by multiple parks, gardens, and nature reserves.
- Medical clinic only a 4-minute drive away.

### Interested in applying?

#### Before applying, make sure:

- The applicant is aged 18 years or over.
- The applicant has approved SDA eligibility and NDIA funding at the appropriate level.
- The applicant has the financial means to pay rent and utilities and is prepared to sign (or a representative to sign) a residential agreement.
- Specialist Disability Accommodation (SDA) category for this house is High Physical Support.

### Find out how this can be your new home

To apply or to arrange an inspection, contact DFFH on:

[westvct@dffh.vic.gov.au](mailto:westvct@dffh.vic.gov.au)

[www.dffh.vic.gov.au](http://www.dffh.vic.gov.au)

For SIL enquiries or for more details contact Scope on:

1300 472 673

[contact@scopeaust.org.au](mailto:contact@scopeaust.org.au)

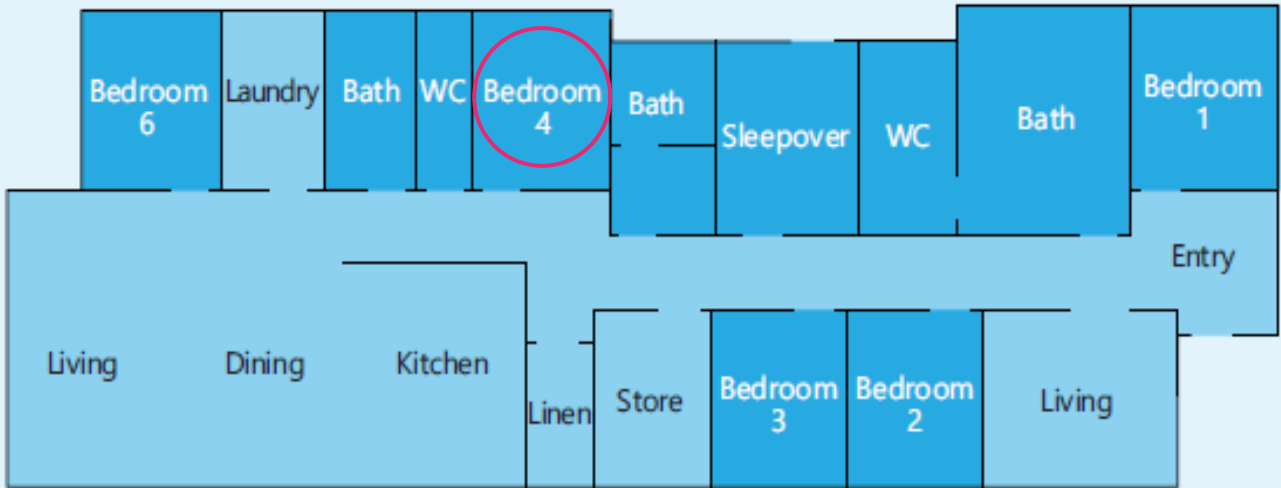

**Making an enquiry**

1300 472 673

[VacancyEnquiries@scopeaust.org.au](mailto:VacancyEnquiries@scopeaust.org.au)