



Supported Independent Living in Glenroy

Property ID: VIC820

Vacancies: 1



Bedrooms:
5



Bathrooms:
2



Property Owner:
Housing Choices
Australia (HCA)



**NDIS Funded
SDA Design Category:**
Improved Liveability



Support provided:
Seven days per week
with sleep over
support model



Five-bedroom home with a great backyard area, close to multiple parks and gardens.

Features

- Open plan kitchen, dining and living area.
- Undercover outdoor seating area perfect for relaxing or entertaining.
- Two separate living rooms.
- Broadband internet access available.
- Wheelchair accessible.
- Property is owned by Housing Choices Australia (HCA) and staff support is provided by Scope.
- Staff have skills and experience in epilepsy and behaviour support.

Current residents

- Four female residents aged between 40-70.
- Their activities and interests include watching television, going out for drives, Arts & Crafts and playing with sensory items.

Bedroom features

- Built-in robes
- Heating and cooling

Local area

- Close to Glenroy train station and bus stops.
- Several cafes, restaurants and shops nearby.
- Short drive to Magnus Medical Glenroy.
- Many reserves and parks within walking distance.

Interested in applying?

Before applying, make sure:

- The applicant is aged 18 years or over.
- The applicant has approved SDA eligibility and NDIA funding at the appropriate level.
- The applicant has the financial means to pay rent and utilities and is prepared to sign (or a representative to sign) a residential agreement.
- The Specialist Disability Accommodation (SDA) design category is Improved Liveability.

Find out how this can be your new home

To apply or to arrange an inspection, contact Housing Choices Australia on:

sda@hcau.org.au

1300 312 447 (ask for the Specialist Housing Group).

For SIL enquiries or for more details contact Scope on:

1300 472 673

contact@scopeaust.org.au

*Your
new home*



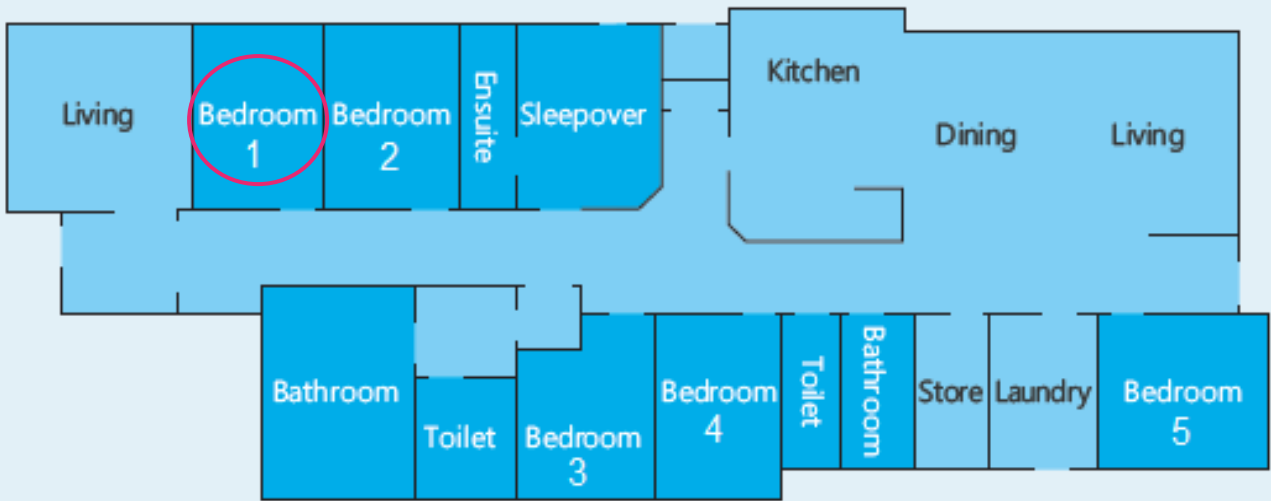

Making an enquiry

1300 472 673

VacancyEnquiries@scopeaust.org.au