



Supported Independent Living in Kew

Property ID: 698

Vacancies: 1



Bedrooms:
5



Bathrooms:
2



Property Owner:
Department of
Families, Fairness &
Housing (DFFH)



**NDIS Funded
SDA Design Category:**
Fully Accessible



Support provided:
Seven days per week
with active night
support model



Five-bedroom home with a great backyard area, close to multiple parks and gardens.

Features

- Open plan kitchen, dining and living area.
- Large, undercover outdoor seating area perfect for relaxing.
- Two separate living rooms.
- Raised veggie patches.
- Broadband internet access available.
- Wheelchair accessible.
- Property is owned by the department of Families, Fairness & Housing (DFFH) and staff support is provided by Scope.

Current residents

- Four male residents aged between 55-75.
- Their activities and interests include sport, listening to music and spending time outdoors.

Bedroom features

- Built-in robes
- Heating and cooling

Local area

- Easy access to public transport with trams and buses within walking distance.
- Close to shops and cafes, including a bustling shopping strip on Kew Junction.
- Beautiful parks and places to enjoy nature nearby, such as Bellbird Park and Alexandra Gardens.

*Your
new home*

Interested in applying?

Before applying, make sure:

- The applicant is aged 18 years or over.
- The applicant has approved SDA eligibility and NDIA funding at the appropriate level.
- The applicant has the financial means to pay rent and utilities and is prepared to sign (or a representative to sign) a residential agreement.
- The Specialist Disability Accommodation (SDA) design category is Fully Accessible.

Find out how this can be your new home

To apply or to arrange an inspection, contact DFFH on:

eastvct@dffh.vic.gov.au
www.dffh.vic.gov.au

For SIL enquiries or for more details contact Scope on:

1300 472 673
contact@scopeaust.org.au

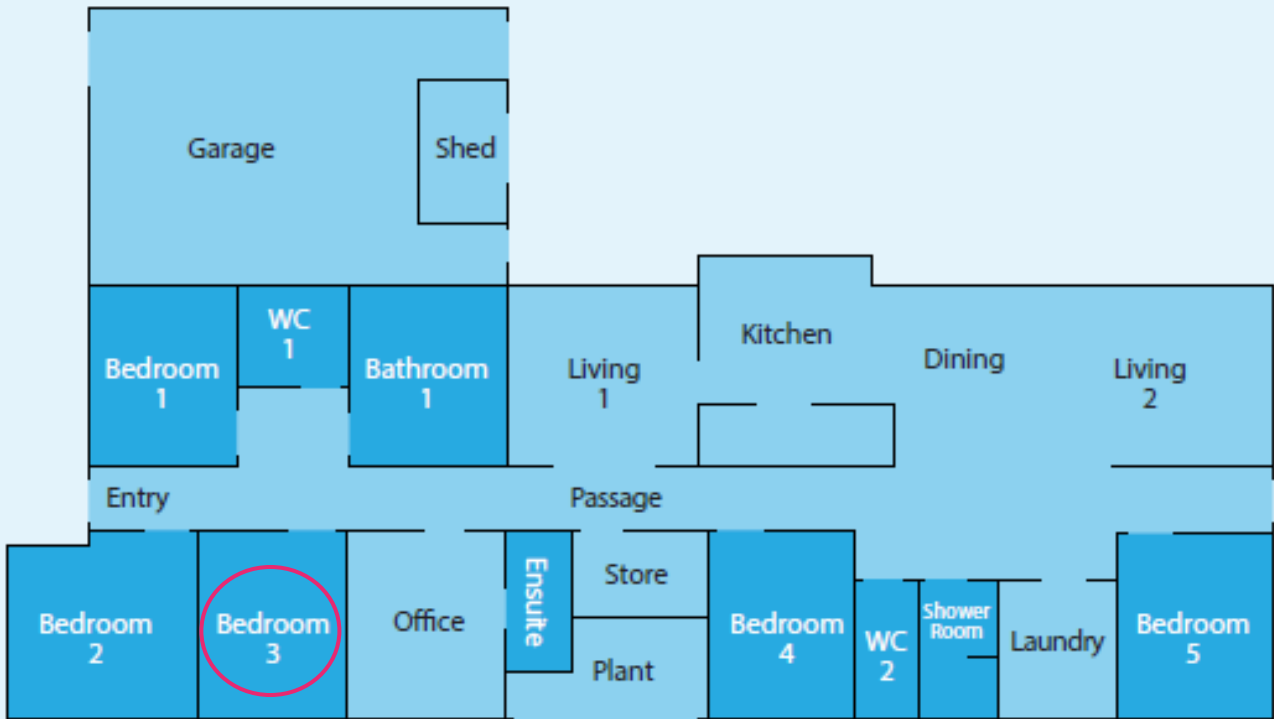

Making an enquiry

1300 472 673

VacancyEnquiries@scopeaust.org.au