



Boronia, VIC 3155



3 Bed



3 Bath



Your SIL Provider: Scope



6 Vacancies (3 in each new house)



Most suitable for: Male or Female



1 min to Boronia Railway Station

2 min to Boronia Shopping Mall / Cinema

3 min to Knox Leisureworks

8 min to Knox Day Hospital



1 min to Genista Reserve / Playground

Modern 3-bedroom homes

A suite of 2 x 3 bedroom houses designed for High Physical Support living. This SDA offers independence, comfort, and contemporary design.

Availability

- Expected opening in April 2025

Property Features

- Modern, purpose-built homes
- Open living, dining and kitchen
- Assistive technology and home automation
- Modern kitchens with customisable features
- Bedrooms with private ensuite
- Expansive backyard and entertainment area
- Fully maintained landscaped garden
- Wheelchair accessible with wide doorways and pathways throughout.
- Boronia Social Connections is also nearby.

To register your interest, please contact us via:

 1300 472 673

 contact@scopeaust.org.au

 scopeaust.org.au





Suitable for

- High Physical Support (HPS) residents



Your Support Team

- Staff are trained to deliver a high level of support across multiple disabilities.
- Staff are trained in supporting participants to access and engage in the local community at a one-to-one level or within a group setting.
- Capacity to implement restrictive practices where required (in line with legislation and best practice).
- Behaviour support / epilepsy / diabetes / mealtime management.
- Sleep over support shift

Site Map

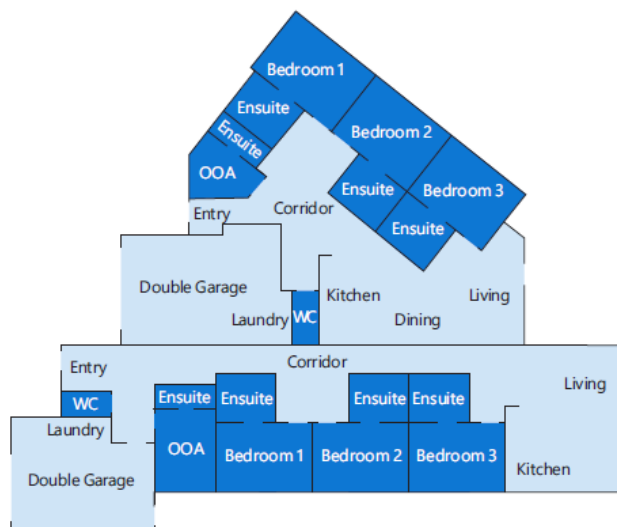

Become a resident of Scope's Supported Independent Living homes and enjoy new surroundings and friends.



To register your interest, please contact us via:

📞 1300 472 673

✉ contact@scopeaust.org.au

🌐 scopeaust.org.au

